



**Carmarthenshire**  
**Application for a premises licence**  
**Licensing Act 2003**

For help contact  
[SCHLicensing@carmarthenshire.gov.uk](mailto:SCHLicensing@carmarthenshire.gov.uk)  
Telephone: 01267 228 924

\* required information

**Section 1 of 21**

You can save the form at any time and resume it later. You do not need to be logged in when you resume.

System reference

Not Currently In Use

This is the unique reference for this application generated by the system.

Your reference

You can put what you want here to help you track applications if you make lots of them. It is passed to the authority.

Are you an agent acting on behalf of the applicant?

Yes  No

Put "no" if you are applying on your own behalf or on behalf of a business you own or work for.

**Applicant Details**

\* First name

Jonathan James

\* Family name

Thomas

\* E-mail

~~XXXXXXXXXXXX@XXXXXX.CO.UK~~

Main telephone number

~~01267 228 924~~

Include country code.

Other telephone number

Indicate here if you would prefer not to be contacted by telephone

Are you:

- Applying as a business or organisation, including as a sole trader  
 Applying as an individual

A sole trader is a business owned by one person without any special legal structure. Applying as an individual means you are applying so you can be employed, or for some other personal reason, such as following a hobby.

**Applicant Business**

Is your business registered in the UK with Companies House?

Yes  No

Note: completing the Applicant Business section is optional in this form.

Is your business registered outside the UK?

Yes  No

Business name

Donuts & Dragons

If your business is registered, use its registered name.

VAT number

- 426727870

Put "none" if you are not registered for VAT.

Legal status

Partnership

Continued from previous page...

Your position in the business

Home country

The country where the headquarters of your business is located.

**Business Address**

If you have one, this should be your official address - that is an address required of you by law for receiving communications.

Building number or name

Street

District

City or town

County or administrative area

Postcode

Country

**Section 2 of 21**

**PREMISES DETAILS**

I/we, as named in section 1, apply for a premises licence under section 17 of the Licensing Act 2003 for the premises described in section 2 below (the premises) and I/we are making this application to you as the relevant licensing authority in accordance with section 12 of the Licensing Act 2003.

**Premises Address**

Are you able to provide a postal address, OS map reference or description of the premises?

- Address     OS map reference     Description

**Postal Address Of Premises**

Building number or name

Street

District

City or town

County or administrative area

Postcode

Country

**Further Details**

Telephone number

Non-domestic rateable value of premises (£)

**Section 3 of 21****APPLICATION DETAILS**

In what capacity are you applying for the premises licence?

- An individual or individuals
- A limited company / limited liability partnership
- A partnership (other than limited liability)
- An unincorporated association
- Other (for example a statutory corporation)
- A recognised club
- A charity
- The proprietor of an educational establishment
- A health service body
- A person who is registered under part 2 of the Care Standards Act 2000 (c14) in respect of an independent hospital in Wales
- A person who is registered under Chapter 2 of Part 1 of the Health and Social Care Act 2008 in respect of the carrying on of a regulated activity (within the meaning of that Part) in an independent hospital in England
- The chief officer of police of a police force in England and Wales

**Confirm The Following**

- I am carrying on or proposing to carry on a business which involves the use of the premises for licensable activities
- I am making the application pursuant to a statutory function
- I am making the application pursuant to a function discharged by virtue of His Majesty's prerogative

**Section 4 of 21****NON INDIVIDUAL APPLICANTS**

Provide name and registered address of applicant in full. Where appropriate give any registered number. In the case of a partnership or other joint venture (other than a body corporate), give the name and address of each party concerned.

**Non Individual Applicant's Name**

Name

**Details**

Registered number (where applicable)

Description of applicant (for example partnership, company, unincorporated association etc)

Continued from previous page...

partner

**Address**

Building number or name	<input type="text" value="2"/>
Street	<input type="text" value="Folland Road"/>
District	<input type="text"/>
City or town	<input type="text" value="Glanamman"/>
County or administrative area	<input type="text" value="Carmarthenshire"/>
Postcode	<input type="text" value="SA18 2BX"/>
Country	<input type="text" value="United Kingdom"/>

**Contact Details**

E-mail	<input type="text" value="[Redacted]"/>
Telephone number	<input type="text" value="[Redacted]"/>
Other telephone number	<input type="text"/>
* Date of birth	<input type="text" value="dd"/> / <input type="text" value="mm"/> / <input type="text" value="yyyy"/>
* Nationality	<input type="text" value="British"/> Documents that demonstrate entitlement to work in the UK

**Non Individual Applicant's Name**

Name	<input type="text" value="Jonathan James Thomas"/>
------	--

**Details**

Registered number (where applicable)	<input type="text"/>
--------------------------------------	----------------------

Description of applicant (for example partnership, company, unincorporated association etc)

<input type="text" value="Partnership"/>
--

Continued from previous page...

### Address

Building number or name	<input type="text" value="2"/>
Street	<input type="text" value="Folland Road"/>
District	<input type="text"/>
City or town	<input type="text" value="Glanamman"/>
County or administrative area	<input type="text"/>
Postcode	<input type="text" value="SA18 2BX"/>
Country	<input type="text" value="United Kingdom"/>

### Contact Details

E-mail	<input type="text" value="REDACTED"/>
Telephone number	<input type="text" value="REDACTED"/>
Other telephone number	<input type="text"/>
Date of birth	<input type="text" value="01"/> / <input type="text" value="06"/> / <input type="text" value="2024"/> dd mm yyyy

Nationality	<input type="text" value="British"/>
	<input type="button" value="Remove this applicant"/>

Documents that demonstrate entitlement to work in the UK

### Section 5 of 21

#### OPERATING SCHEDULE

When do you want the premises licence to start?	<input type="text" value="01"/> / <input type="text" value="06"/> / <input type="text" value="2024"/> dd mm yyyy
---	---

If you wish the licence to be valid only for a limited period, when do you want it to end	<input type="text"/> / <input type="text"/> / <input type="text"/> dd mm yyyy
---	--

Provide a general description of the premises

For example the type of premises, its general situation and layout and any other information which could be relevant to the licensing objectives. Where your application includes off-supplies of alcohol and you intend to provide a place for consumption of these off-supplies you must include a description of where the place will be and its proximity to the premises.

7b King Street is a ground floor property on the busy thoroughfare of King Street in central Carmarthen. The property consists of a porch area, glass frontage and open plan public area. There is a storage room and 2 toilets to the rear of the property and access to a small maisonette area that will be accessible to staff only.

**Continued from previous page...**

If 5,000 or more people are expected to attend the premises at any one time, state the number expected to attend

**Section 6 of 21**

**PROVISION OF PLAYS**

See guidance on regulated entertainment

Will you be providing plays?

Yes

No

**Section 7 of 21**

**PROVISION OF FILMS**

See guidance on regulated entertainment

Will you be providing films?

Yes

No

**Section 8 of 21**

**PROVISION OF INDOOR SPORTING EVENTS**

See guidance on regulated entertainment

Will you be providing indoor sporting events?

Yes

No

**Section 9 of 21**

**PROVISION OF BOXING OR WRESTLING ENTERTAINMENTS**

See guidance on regulated entertainment

Will you be providing boxing or wrestling entertainments?

Yes

No

**Section 10 of 21**

**PROVISION OF LIVE MUSIC**

See guidance on regulated entertainment

Will you be providing live music?

Yes

No

**Section 11 of 21**

**PROVISION OF RECORDED MUSIC**

See guidance on regulated entertainment

Will you be providing recorded music?

Yes

No

**Standard Days And Timings**

Continued from previous page...

MONDAY

Start

End

Start

End

Give timings in 24 hour clock.  
(e.g., 16:00) and only give details for the days  
of the week when you intend the premises  
to be used for the activity.

TUESDAY

Start

End

Start

End

WEDNESDAY

Start

End

Start

End

THURSDAY

Start

End

Start

End

FRIDAY

Start

End

Start

End

SATURDAY

Start

End

Start

End

SUNDAY

Start

End

Start

End

Will the playing of recorded music take place indoors or outdoors or both?

Indoors

Outdoors

Both

Where taking place in a building or other  
structure tick as appropriate. Indoors may  
include a tent.

State type of activity to be authorised, if not already stated, and give relevant further details, for example (but not  
exclusively) whether or not music will be amplified or unamplified.

the streaming of music from radio or Spotify through a speaker system

State any seasonal variations for playing recorded music

For example (but not exclusively) where the activity will occur on additional days during the summer months.

Continued from previous page...

Non-standard timings. Where the premises will be used for the playing of recorded music at different times from those listed in the column on the left, list below

For example (but not exclusively), where you wish the activity to go on longer on a particular day e.g. Christmas Eve.

New year's eve until 01:00

**Section 12 of 21**

**PROVISION OF PERFORMANCES OF DANCE**

See guidance on regulated entertainment

Will you be providing performances of dance?

Yes  No

**Section 13 of 21**

**PROVISION OF ANYTHING OF A SIMILAR DESCRIPTION TO LIVE MUSIC, RECORDED MUSIC OR PERFORMANCES OF DANCE**

See guidance on regulated entertainment

Will you be providing anything similar to live music, recorded music or performances of dance?

Yes  No

**Section 14 of 21**

**LATE NIGHT REFRESHMENT**

Will you be providing late night refreshment?

Yes  No

**Section 15 of 21**

**SUPPLY OF ALCOHOL**

Will you be selling or supplying alcohol?

Yes  No

**Standard Days And Timings**

MONDAY

Start

End

Start

End

TUESDAY

Start

End

Start

End

Give timings in 24 hour clock.  
(e.g., 16:00) and only give details for the days  
of the week when you intend the premises  
to be used for the activity.



Continued from previous page...

WEDNESDAY

Start  End   
Start  End

THURSDAY

Start  End   
Start  End

FRIDAY

Start  End   
Start  End

SATURDAY

Start  End   
Start  End

SUNDAY

Start  End   
Start  End

Will the sale of alcohol be for consumption:

- On the premises     Off the premises     Both

If the sale of alcohol is for consumption on the premises select on, if the sale of alcohol is for consumption away from the premises select off. If the sale of alcohol is for consumption on the premises and away from the premises select both.

State any seasonal variations

For example (but not exclusively) where the activity will occur on additional days during the summer months.

Non-standard timings. Where the premises will be used for the supply of alcohol at different times from those listed in the column on the left, list below

For example (but not exclusively), where you wish the activity to go on longer on a particular day e.g. Christmas Eve.

New years eve from 12:00 until 00:30

State the name and details of the individual whom you wish to specify on the licence as premises supervisor

*Continued from previous page...*

**Name**

First name

Family name

Date of birth  /  /   
dd mm yyyy

**Enter the contact's address**

Building number or name

Street

District

City or town

County or administrative area

Postcode

Country

Personal Licence number (if known)

Issuing licensing authority (if known)

**PROPOSED DESIGNATED PREMISES SUPERVISOR CONSENT**

How will the consent form of the proposed designated premises supervisor be supplied to the authority?

- Electronically, by the proposed designated premises supervisor
- As an attachment to this application

Reference number for consent form (if known)

If the consent form is already submitted, ask the proposed designated premises supervisor for its 'system reference' or 'your reference'.

**Section 16 of 21**

**ADULT ENTERTAINMENT**

Highlight any adult entertainment or services, activities, or other entertainment or matters ancillary to the use of the premises that may give rise to concern in respect of children

Give information about anything intended to occur at the premises or ancillary to the use of the premises which may give rise to concern in respect of children, regardless of whether you intend children to have access to the premises, for example (but not exclusively) nudity or semi-nudity, films for restricted age groups etc gambling machines etc.

Continued from previous page...

**Section 17 of 21**

**HOURS PREMISES ARE OPEN TO THE PUBLIC**

**Standard Days And Timings**

MONDAY

Start

End

Start

End

Give timings in 24 hour clock.  
(e.g., 16:00) and only give details for the days  
of the week when you intend the premises  
to be used for the activity.

TUESDAY

Start

End

Start

End

WEDNESDAY

Start

End

Start

End

THURSDAY

Start

End

Start

End

FRIDAY

Start

End

Start

End

SATURDAY

Start

End

Start

End

SUNDAY

Start

End

Start

End

State any seasonal variations

For example (but not exclusively) where the activity will occur on additional days during the summer months.

Non standard timings. Where you intend to use the premises to be open to the members and guests at different times from those listed in the column on the left, list below

For example (but not exclusively), where you wish the activity to go on longer on a particular day e.g. Christmas Eve.

New Year's Eve until 01:00

Continued from previous page...

**Section 18 of 21**

**LICENSING OBJECTIVES**

Describe the steps you intend to take to promote the four licensing objectives:

a) General – all four licensing objectives (b,c,d,e)

List here steps you will take to promote all four licensing objectives together.

Our staff will regularly have refresher training on licensing laws.  
Alcohol will be securely kept behind the bar before being purchased.  
Staff will conduct regular floor walks to make sure no customers are giving alcohol to people under 18 and that no customers appear intoxicated.

b) The prevention of crime and disorder

We will work with the local community and local police force to keep up to date with current issues and problematic individuals.  
We have a security system (including CCTV) installed on the premises  
A notice is displayed in the entrance advising that CCTV is in operation  
All instances of crime and disorder will be reported to the police as soon as reasonably practicable  
We have an anti-drugs policy in place  
All-inclusive nights or other irresponsible drinks promotions will not be permitted  
Crime prevention notices will be displayed warning customers of the possibility of crime which may target them (e.g. Bags should not be left unattended)  
We provide food that is available at all times when the premises is open.  
We have a policy on the safe management of large groups (e.g. stag and hen parties)

c) Public safety

We will vigilantly monitor alcohol consumption of our customers and refuse anyone who we deem unfit to consume more.  
Free drinking water will be available at all times when the premises is open to the public.  
A fire risk assessment will be in place and regular fire drills will take place each month.  
Exit doors will be easily signposted and maintained  
Step and stair edges are appropriately highlighted so as to be conspicuous.  
At least one trained First Aider will be on duty when the public are present and adequate and appropriate first Aid equipment will be available  
We operate a complete no smoking policy at the premises

d) The prevention of public nuisance

Prominent, clear and legible notices are displayed at the exit requesting customers to respect the needs of local residents and to leave the premises and area quietly.  
Customers will not be permitted to take containers of alcohol or soft drinks from the premises  
All windows are double glazed to minimize the breakout of noise.

e) The protection of children from harm

We will operate using the challenge 25 scheme, and nobody under 18 will be allowed to purchase or consume alcohol on our premises.  
Anyone suspected of being under the age of 18 or purchasing for anyone under age of 18 will be refused.  
All children under the age of 12 must be accompanied by an adult to access the premises.

Continued from previous page...

Children will not be permitted on site after 1900

## Section 19 of 21

### NOTES ON DEMONSTRATING ENTITLEMENT TO WORK IN THE UK

#### Entitlement to work/immigration status for individual applicants and applications from partnerships which are not limited liability partnerships:

A licence may not be held by an individual or an individual in a partnership who is resident in the UK who:

- does not have the right to live and work in the UK; or
- is subject to a condition preventing him or her from doing work relating to the carrying on of a licensable activity.

Any premises licence issued in respect of an application made on or after 6 April 2017 will become invalid if the holder ceases to be entitled to work in the UK.

Applicants must demonstrate that they have an entitlement to work in the UK and are not subject to a condition preventing them from doing work relating to the carrying on of a licensable activity. They do this in one of two ways: 1) by providing with this application copies or scanned copies of the documents listed below (which do not need to be certified), or 2) by providing their 'share code' to enable the licensing authority to carry out a check using the Home Office online right to work checking service (see below).

#### Documents which demonstrate entitlement to work in the UK

- An expired or current passport showing the holder, or a person named in the passport as the child of the holder, is A British citizen or a citizen of the UK and Colonies having the right of abode in the UK [please see note below about which sections of the passport to copy].
- An expired or current passport or national identity card showing the holder, or a person named in the passport as the child of the holder, is a national of a European Economic Area country or Switzerland.
- A Registration Certificate or document certifying permanent residence issued by the Home Office to a national of a European Economic Area country or Switzerland.
- A Permanent Residence Card issued by the Home Office to the family member of a national of a European Economic Area country or Switzerland.
- A **current** Biometric Immigration Document (Biometric Residence Permit) issued by the Home Office to the holder indicating that the person named is allowed to stay indefinitely in the UK, or has no time limit on their stay in the UK.
- A **current** passport endorsed to show that the holder is exempt from immigration control, is allowed to stay indefinitely in the UK, has the right of abode in the UK, or has no time limit on their stay in the UK.
- A **current** Immigration Status Document issued by the Home Office to the holder with an endorsement indicating that the named person is allowed to stay indefinitely in the UK or has no time limit on their stay in the UK, **when produced in combination with** an official document giving the person's permanent National Insurance number and their name issued by a Government agency or a previous employer.
- A birth or adoption certificate issued in the UK, **when produced in combination with** an official document giving the person's permanent National Insurance number and their name issued by a Government agency or a previous employer.
- A birth or adoption certificate issued in the Channel Islands, the Isle of Man or Ireland **when produced in combination with** an official document giving the person's permanent National Insurance number and their name issued by a Government agency or a previous employer.
- A certificate of registration or naturalisation as a British citizen, **when produced in combination with** an official document giving the person's permanent National Insurance number and their name issued by a Government agency or a previous employer.

*Continued from previous page...*

- A **current** passport endorsed to show that the holder is allowed to stay in the UK and is currently allowed to work and is not subject to a condition preventing the holder from doing work relating to the carrying on of a licensable activity.
- A **current** Biometric Immigration Document (Biometric Residence Permit) issued by the Home Office to the holder which indicates that the named person can currently stay in the UK and is allowed to work relation to the carrying on of a licensable activity.
- A **current** Residence Card issued by the Home Office to a person who is not a national of a European Economic Area state or Switzerland but who is a family member of such a national or who has derivative rights or residence.
- A **current** Immigration Status Document containing a photograph issued by the Home Office to the holder with an endorsement indicating that the named person may stay in the UK, and is allowed to work and is not subject to a condition preventing the holder from doing work relating to the carrying on of a licensable activity **when produced in combination with** an official document giving the person’s permanent National Insurance number and their name issued by a Government agency or a previous employer.
- A Certificate of Application, **less than 6 months old**, issued by the Home Office under regulation 18(3) or 20(2) of the Immigration (European Economic Area) Regulations 2016, to a person who is not a national of a European Economic Area state or Switzerland but who is a family member of such a national or who has derivative rights of residence.
- Reasonable evidence that the person has an outstanding application to vary their permission to be in the UK with the Home Office such as the Home Office acknowledgement letter or proof of postage evidence, or reasonable evidence that the person has an appeal or administrative review pending on an immigration decision, such as an appeal or administrative review reference number.
- Reasonable evidence that a person who is not a national of a European Economic Area state or Switzerland but who is a family member of such a national or who has derivative rights of residence in exercising treaty rights in the UK including:-
  - evidence of the applicant’s own identity – such as a passport,
  - evidence of their relationship with the European Economic Area family member – e.g. a marriage certificate, civil partnership certificate or birth certificate, and
  - evidence that the European Economic Area national has a right of permanent residence in the UK or is one of the following if they have been in the UK for more than 3 months:
    - (i) working e.g. employment contract, wage slips, letter from the employer,
    - (ii) self-employed e.g. contracts, invoices, or audited accounts with a bank,
    - (iii) studying e.g. letter from the school, college or university and evidence of sufficient funds; or
    - (iv) self-sufficient e.g. bank statements.

Family members of European Economic Area nationals who are studying or financially independent must also provide evidence that the European Economic Area national and any family members hold comprehensive sickness insurance in the UK. This can include a private medical insurance policy, an EHIC card or an S1, S2 or S3 form.

**Original documents must not be sent to licensing authorities.** If the document copied is a passport, a copy of the following pages should be provided:-

- (i) any page containing the holder’s personal details including nationality;
- (ii) any page containing the holder’s photograph;
- (iii) any page containing the holder’s signature;
- (iv) any page containing the date of expiry; and
- (v) any page containing information indicating the holder has permission to enter or remain in the UK and is permitted to work.

***Continued from previous page...***

If the document is not a passport, a copy of the whole document should be provided.

Your right to work will be checked as part of your licensing application and this could involve us checking your immigration status with the Home Office. We may otherwise share information with the Home Office. Your licence application will not be determined until you have complied with this guidance.

#### **Home Office online right to work checking service**

As an alternative to providing a copy of the documents listed above, applicants may demonstrate their right to work by allowing the licensing authority to carry out a check with the Home Office online right to work checking service.

To demonstrate their right to work via the Home Office online right to work checking service, applicants should include in this application their 9-digit share code (provided to them upon accessing the service at <https://www.gov.uk/prove-right-to-work>) which, along with the applicant's date of birth (provided within this application), will allow the licensing authority to carry out the check.

In order to establish the applicant's right to work, the check will need to indicate that the applicant is allowed to work in the United Kingdom and is not subject to a condition preventing them from doing work relating to the carrying on of a licensable activity.

An online check will not be possible in all circumstances because not all applicants will have an immigration status that can be checked online. The Home Office online right to work checking service sets out what information and/or documentation applicants will need in order to access the service. Applicants who are unable to obtain a share code from the service should submit copy documents as set out above.

**Section 20 of 21**

**NOTES ON REGULATED ENTERTAINMENT**

*Continued from previous page...*

In terms of specific **regulated entertainments** please note that:

- Plays: no licence is required for performances between 08:00 and 23.00 on any day, provided that the audience does not exceed 500.
- Films: no licence is required for 'not-for-profit' film exhibition held in community premises between 08.00 and 23.00 on any day provided that the audience does not exceed 500 and the organiser (a) gets consent to the screening from a person who is responsible for the premises; and (b) ensures that each such screening abides by age classification ratings.
- Indoor sporting events: no licence is required for performances between 08.00 and 23.00 on any day, provided that the audience does not exceed 1000.
- Boxing or Wrestling Entertainment: no licence is required for a contest, exhibition or display of Greco-Roman wrestling, or freestyle wrestling between 08.00 and 23.00 on any day, provided that the audience does not exceed 1000. Combined fighting sports – defined as a contest, exhibition or display which combines boxing or wrestling with one or more martial arts – are licensable as a boxing or wrestling entertainment rather than an indoor sporting event.
- Live music: no licence permission is required for:
  - o a performance of unamplified live music between 08.00 and 23.00 on any day, on any premises.
  - o a performance of amplified live music between 08.00 and 23.00 on any day on premises authorised to sell alcohol for consumption on those premises, provided that the audience does not exceed 500.
  - o a performance of amplified live music between 08.00 and 23.00 on any day, in a workplace that is not licensed to sell alcohol on those premises, provided that the audience does not exceed 500.
  - o a performance of amplified live music between 08.00 and 23.00 on any day, in a church hall, village hall, community hall, or other similar community premises, that is not licensed by a premises licence to sell alcohol, provided that (a) the audience does not exceed 500, and (b) the organiser gets consent for the performance from a person who is responsible for the premises.
  - o a performance of amplified live music between 08.00 and 23.00 on any day, at the non-residential premises of (i) a local authority, or (ii) a school, or (iii) a hospital, provided that (a) the audience does not exceed 500, and (b) the organiser gets consent for the performance on the relevant premises from: (i) the local authority concerned, or (ii) the school or (iii) the health care provider for the hospital.
- Recorded Music: no licence permission is required for:
  - o any playing of recorded music between 08.00 and 23.00 on any day on premises authorised to sell alcohol for consumption on those premises, provided that the audience does not exceed 500.
  - o any playing of recorded music between 08.00 and 23.00 on any day, in a church hall, village hall, community hall, or other similar community premises, that is not licensed by a premises licence to sell alcohol, provided that (a) the audience does not exceed 500, and (b) the organiser gets consent for the performance from a person who is responsible for the premises.
  - o any playing of recorded music between 08.00 and 23.00 on any day, at the non-residential premises of (i) a local authority, or (ii) a school, or (iii) a hospital, provided that (a) the audience does not exceed 500, and (b) the organiser gets consent for the performance on the relevant premises from: (i) the local authority concerned, or (ii) the school proprietor or (iii) the health care provider for the hospital.



**Continued from previous page...**

- Dance: no licence is required for performances between 08.00 and 23.00 on any day, provided that the audience does not exceed 500. However, a performance which amounts to adult entertainment remains licensable.
- Cross activity exemptions: no licence is required between 08.00 and 23.00 on any day, with no limit on audience size for:
  - o any entertainment taking place on the premises of the local authority where the entertainment is provided by or on behalf of the local authority;
  - o any entertainment taking place on the hospital premises of the health care provider where the entertainment is provided by or on behalf of the health care provider;
  - o any entertainment taking place on the premises of the school where the entertainment is provided by or on behalf of the school proprietor; and
  - o any entertainment (excluding films and a boxing or wrestling entertainment) taking place at a travelling circus, provided that (a) it takes place within a moveable structure that accommodates the audience, and (b) that the travelling circus has not been located on the same site for more than 28 consecutive days.

**Section 21 of 21**

**PAYMENT DETAILS**

This fee must be paid to the authority. If you complete the application online, you must pay it by debit or credit card.

For detailed guidance on the fee structure, please refer to the table on Page 4, 5 and 6 of the guidance document.

\* Fee amount (£)

190.00

**ATTACHMENTS**

**AUTHORITY POSTAL ADDRESS**

**Address**

Building number or name

Street

District

City or town

County or administrative area

Postcode

Country

United Kingdom

**DECLARATION**

[APPLICABLE TO INDIVIDUAL APPLICANTS ONLY, INCLUDING THOSE IN A PARTNERSHIP WHICH IS NOT A LIMITED LIABILITY PARTNERSHIP] I UNDERSTAND I AM NOT ENTITLED TO BE ISSUED WITH A LICENCE IF I DO NOT HAVE THE ENTITLEMENT TO LIVE AND WORK IN THE UK (OR IF I AM SUBJECT TO A CONDITION PREVENTING ME FROM DOING WORK RELATING TO THE CARRYING ON OF A LICENSABLE ACTIVITY) AND THAT MY LICENCE WILL BECOME INVALID IF I CEASE TO BE ENTITLED TO LIVE AND WORK IN THE UK (PLEASE READ GUIDANCE NOTE 15).

\* I understand that I must now advertise my application.

\* I understand that if I do not comply with the requirements my application will be rejected.

**Continued from previous page...**

[Applicable to individual applicants only, including those in a partnership which is not a limited liability partnership] I

\* understand I am not entitled to be issued with a licence if I do not have the entitlement to live and work in the UK (or if I am subject to a condition preventing me from doing work relating to the carrying on of a licensable activity) and that my licence will become invalid if I cease to be entitled to live and work in the UK (please read guidance note 15).

The DPS named in this application form is entitled to work in the UK (and is not subject to conditions preventing him or her from doing work relating to a licensable activity) and I have seen a copy of his or her proof of entitlement to work, if appropriate (please see note 15)

Ticking this box indicates you have read and understood the above declaration

This section should be completed by the applicant, unless you answered "Yes" to the question "Are you an agent acting on behalf of the applicant?"

\* Full name

\* Capacity

Date (dd/mm/yyyy)

\* Full name

\* Capacity

Date (dd/mm/yyyy)

Once you're finished you need to do the following:

1. Save this form to your computer by clicking file/save as...

2. Go back to <https://www.gov.uk/apply-for-a-licence/premises-licence/carmarthenshire/apply-1> to upload this file and continue with your application.

Don't forget to make sure you have all your supporting documentation to hand.

**IT IS AN OFFENCE LIABLE TO SUMMARY CONVICTION TO A FINE OF ANY AMOUNT UNDER SECTION 158 OF THE LICENSING ACT 2003, TO MAKE A FALSE STATEMENT IN OR IN CONNECTION WITH THIS APPLICATION**

**IT IS AN OFFENCE UNDER SECTION 24B OF THE IMMIGRATION ACT 1971 FOR A PERSON TO WORK WHEN THEY KNOW, OR HAVE REASONABLE CAUSE TO BELIEVE, THAT THEY ARE DISQUALIFIED FROM DOING SO BY REASON OF THEIR IMMIGRATION STATUS. THOSE WHO EMPLOY AN ADULT WITHOUT LEAVE OR WHO IS SUBJECT TO CONDITIONS AS TO EMPLOYMENT WILL BE LIABLE TO A CIVIL PENALTY UNDER SECTION 15 OF THE IMMIGRATION, ASYLUM AND NATIONALITY ACT 2006 AND PURSUANT TO SECTION 21 OF THE SAME ACT, WILL BE COMMITTING AN OFFENCE WHERE THEY DO SO IN THE KNOWLEDGE, OR WITH REASONABLE CAUSE TO BELIEVE, THAT THE EMPLOYEE IS DISQUALIFIED**

**Consent of individual to being specified as premises supervisor**

I JONATHAN JAMES THOMAS

*[full name of prospective premises supervisor]*

of

2 FOLLAND ROAD  
GLANAMMAN  
SA18 2BX

*[home address of prospective premises supervisor]*

hereby confirm that I give my consent to be specified as the designated premises supervisor in relation to the application for

PREMISES LICENCE

*[type of application]*

by

JONATHAN JAMES THOMAS

*[name of applicant]*

relating to a premises licence

*[number of existing licence, if any]*

for

DONUTS & DRAGONS  
7B KING STREET  
CARMARTHEN  
SA31 1BD

*[name and address of premises to which the application relates]*

and any premises licence to be granted or varied in respect of this application made by

JONATHAN JAMES THOMAS

*[name of applicant]*

concerning the supply of alcohol at

DONUTS & DRAGONS  
7B KING STREET  
CARMARTHEN  
SA31 1BD

*[name and address of premises to which application relates]*

I also confirm that I am entitled to work in the United Kingdom and am applying for, intend to apply for or currently hold a personal licence, details of which I set out below.

Personal licence number

CCC104667

*[insert personal licence number, if any]*

Personal licence issuing authority

CARDIFF COUNTY COUNCIL

*[insert name and address and telephone number of personal licence issuing authority, if any]*

Signed

J Thomas

Name (please print)

JONATHAN JAMES THOMAS

Date

14.05.2024

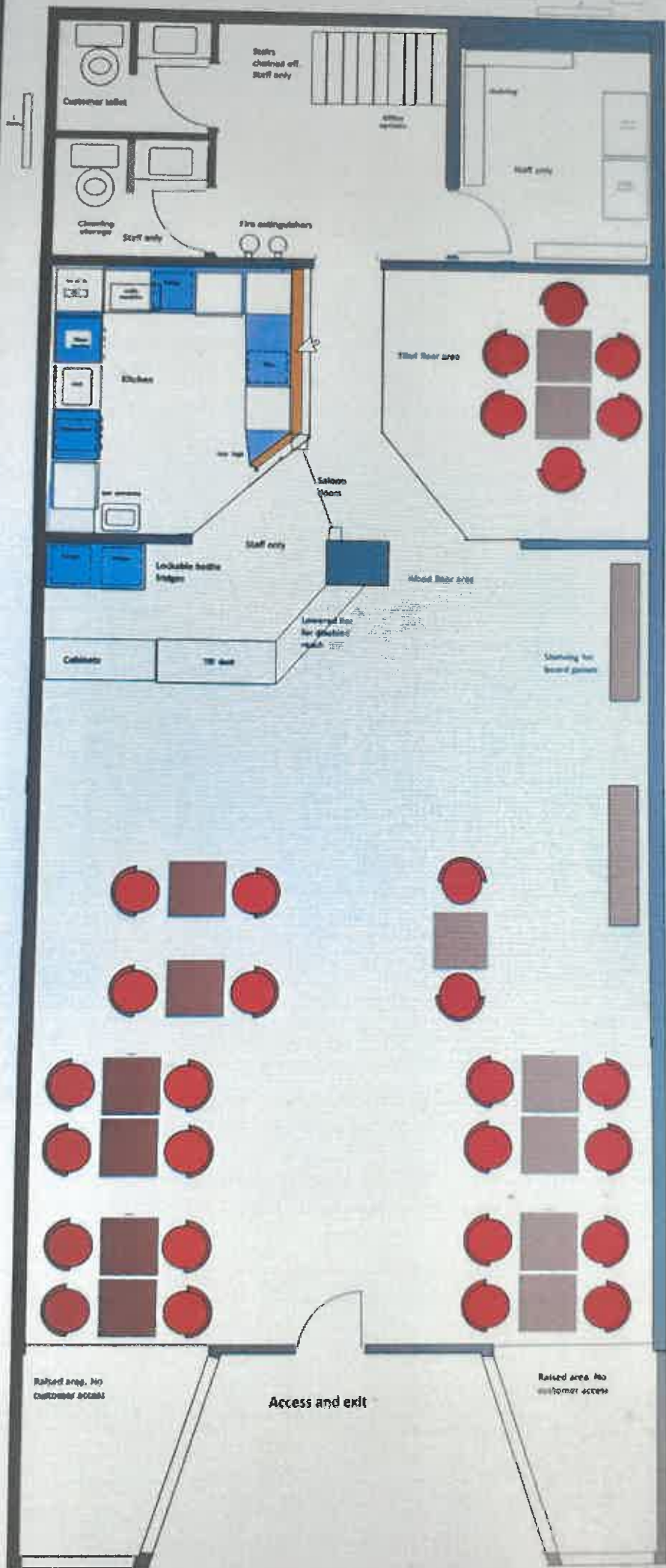

21%

09:02

23/07/2024

Search

Windows taskbar icons

## **Cumulative Impact Assessment**

We are aware that our premises licence application falls under an area where a Cumulative Impact Assessment has been carried out.

We wish for our business to run in an area that is safe and free from crime and antisocial behaviour. We want to work with the council and the local police to ensure this continues.

However, we feel that being granted a premises licence would not be a detriment to the community.

Along with the evidence already given in our application, we would like clarify a few more points in regards to the licensing objectives:

- We are predominantly a board game cafe. We are designed, and advertised, as a family friendly place to enjoy social board gaming and events. Our USP is board games and the provision of alcohol is to allow customers to enjoy a drink while playing games.
- We will only have a small selection of alcoholic beverages on sale which will only be permitted to be drunk on site. No drinks will be allowed to leave the premises.
- All drinks will be served to the table. There will be no standing service, and all customers will be required to sit at a table. There will be the opportunity to purchase food and soft drinks, and there will be free access to water.
- We feel that providing the option for alcoholic beverages will help increase that footfall we receive to our business. We are determined to be a safe, welcoming space in the community and will not tolerate antisocial behaviour in our around our premises.