



Carmarthenshire
Application to vary a premises licence
Licensing Act 2003

For help contact
SCHLicensing@carmarthenshire.gov.uk
 Telephone: 01267 228 924

* required information

Section 1 of 18

You can save the form at any time and resume it later. You do not need to be logged in when you resume.

System reference

Not Currently In Use

This is the unique reference for this application generated by the system.

Your reference

You can put what you want here to help you track applications if you make lots of them. It is passed to the authority.

Are you an agent acting on behalf of the applicant?

Yes No

Put "no" if you are applying on your own behalf or on behalf of a business you own or work for.

Applicant Details

* First name

Daniel

* Family name

Davies

* E-mail

daniel.clockworktaVERN@gmail.com

Main telephone number

07568304939

Include country code.

Other telephone number

Indicate here if you would prefer not to be contacted by telephone

Are you:

Applying as a business or organisation, including as a sole trader
 Applying as an individual

A sole trader is a business owned by one person without any special legal structure. Applying as an individual means you are applying so you can be employed, or for some other personal reason, such as following a hobby.

Applicant Business

Is your business registered in the UK with Companies House? Yes No

Note: completing the Applicant Business section is optional in this form.

Registration number

03389199

Business name

Scarlets Regional Ltd.

If your business is registered, use its registered name.

VAT number

GB 700885933

Put "none" if you are not registered for VAT.

Legal status

Private Limited Company

Continued from previous page...Your position in the business Home country

The country where the headquarters of your business is located.

Registered Address

Address registered with Companies House.

Building number or name Street District City or town County or administrative area Postcode Country **Section 2 of 18****APPLICATION DETAILS**

This application cannot be used to vary the licence so as to extend the period for which the licence has effect or to vary substantially the premises to which it relates. If you wish to make that type of change to the premises licence, you should make a new premises licence application under section 17 of the Licensing Act 2003.

I/we, as named in section 1, being the premises licence holder, apply to vary a premises licence under section 34 of the Licensing Act 2003 for the premises described in section 2 below.

* Premises Licence Number

Are you able to provide a postal address, OS map reference or description of the premises?

 Address OS map reference Description
Postal Address Of PremisesBuilding number or name Street District City or town County or administrative area Postcode Country **Premises Contact Details**Telephone number

Continued from previous page...

Non-domestic rateable
value of premises (£)

79,500

Section 3 of 18**VARIATION**Do you want the proposed
variation to have effect as
soon as possible? Yes NoDo you want the proposed variation to have effect in relation to the
introduction of the late night levy? Yes NoYou do not have to pay a fee if the only
purpose of the variation for which you are
applying is to avoid becoming liable to the
late night levy.If your proposed variation
would mean that 5,000 or
more people are expected to
attend the premises at any
one time, state the number
expected to attend**Describe Briefly The Nature Of The Proposed Variation**

Describe the premises. For example the type of premises, its general situation and layout and any other information which could be relevant to the licensing objectives. Where your application includes off-supplies of alcohol and you intend to provide a place for consumption of these off-supplies, you must include a description of where the place will be and its proximity to the premises.

Section 4 of 18**PROVISION OF PLAYS**[See guidance on regulated entertainment](#)Will the schedule to provide plays be subject to change if this application to
vary is successful? Yes No**Section 5 of 18****PROVISION OF FILMS**[See guidance on regulated entertainment](#)Will the schedule to provide films be subject to change if this application to
vary is successful? Yes No**Section 6 of 18****PROVISION OF INDOOR SPORTING EVENTS**

Continued from previous page...

[See guidance on regulated entertainment](#)

Will the schedule to provide indoor sporting events be subject to change if this application to vary is successful?

Yes No

Section 7 of 18

PROVISION OF BOXING OR WRESTLING ENTERTAINMENTS

[See guidance on regulated entertainment](#)

Will the schedule to provide boxing or wrestling entertainments be subject to change if this application to vary is successful?

Yes No

Section 8 of 18

PROVISION OF LIVE MUSIC

[See guidance on regulated entertainment](#)

Will the schedule to provide live music be subject to change if this application to vary is successful?

Yes No

Section 9 of 18

PROVISION OF RECORDED MUSIC

[See guidance on regulated entertainment](#)

Will the schedule to provide recorded music be subject to change if this application to vary is successful?

Yes No

Standard Days And Timings

MONDAY

Start

End

Start

End

TUESDAY

Start

End

Start

End

WEDNESDAY

Start

End

Start

End

THURSDAY

Start

End

Start

End

Provide timings in 24 hour clock (e.g., 16:00) and only give details for the days of the week when you intend the premises to be used for the activity.

Continued from previous page...

FRIDAY

Start

End

Start

End

SATURDAY

Start

End

Start

End

SUNDAY

Start

End

Start

End

Will the playing of recorded music take place indoors or outdoors or both?

Indoors Outdoors Both

Where taking place in a building or other structure select as appropriate. Indoors may include a tent.

State type of activity to be authorised, if not already stated, and give relevant further details, for example (but not exclusively) whether or not music will be amplified or unamplified.

State any seasonal variations for playing recorded music.

For example (but not exclusively) where the activity will occur on additional days during the summer months.

Non-standard timings. Where the premises will be used for the playing of recorded music at different times from those listed above, list below.

For example (but not exclusively), where you wish the activity to go on longer on a particular day e.g. Christmas Eve.

Section 10 of 18

PROVISION OF PERFORMANCES OF DANCE

[See guidance on regulated entertainment](#)

Will the schedule to provide performances of dance be subject to change if this application to vary is successful?

Yes No

Section 11 of 18

Continued from previous page...

PROVISION OF ANYTHING OF A SIMILAR DESCRIPTION TO LIVE MUSIC, RECORDED MUSIC OR PERFORMANCES OF DANCE

[See guidance on regulated entertainment](#)

Will the schedule to provide anything similar to live music, recorded music or performances of dance be subject to change if this application to vary is successful?

- Yes No

Standard Days And Timings

MONDAY

Start

End

Start

End

Provide timings in 24 hour clock (e.g., 16:00) and only give details for the days of the week when you intend the premises to be used for the activity.

TUESDAY

Start

End

Start

End

WEDNESDAY

Start

End

Start

End

THURSDAY

Start

End

Start

End

FRIDAY

Start

End

Start

End

SATURDAY

Start

End

Start

End

SUNDAY

Start

End

Start

End

Provide a description of the type of entertainment that will be provided.

Background recorded music

Continued from previous page...

Will this entertainment take place indoors or outdoors or both?

Indoors Outdoors Both

Where taking place in a building or other structure select as appropriate. Indoors may include a tent.

State type of activity to be authorised, if not already stated, and give relevant further details, for example (but not exclusively) whether or not music will be amplified or unamplified.

from 1am - 2am, music will be played at background levels to allow customers to wind down and finish their drinks before they leave the premises

State any seasonal variations for entertainment.

For example (but not exclusively) where the activity will occur on additional days during the summer months.

Bank Holiday Sundays, we'd like our recorded music to be allowed until 2am.

Non-standard timings. Where the premises will be used for entertainment at different times from those listed above, list below.

For example (but not exclusively), where you wish the activity to go on longer on a particular day e.g. Christmas Eve.

Christmas Eve, Boxing Day, New Years Eve & New Years Day, we'd like our recorded music to be allowed until 2am

Section 12 of 18

PROVISION OF LATE NIGHT REFRESHMENT

Will the schedule to provide late night refreshment be subject to change if this application to vary is successful?

Yes No

Section 13 of 18

SUPPLY OF ALCOHOL

Will the schedule to supply alcohol be subject to change if this application to vary is successful?

Yes No

Standard Days And Timings

MONDAY

Start

End

Start

End

Provide timings in 24 hour clock (e.g., 16:00) and only give details for the days of the week when you intend the premises to be used for the activity.

Continued from previous page...

TUESDAY

Start 08:00

End 00:00

Start

End

WEDNESDAY

Start 08:00

End 00:00

Start

End

THURSDAY

Start 08:00

End 00:00

Start

End

FRIDAY

Start 08:00

End 02:30

Start

End

SATURDAY

Start 08:00

End 02:30

Start

End

SUNDAY

Start 08:00

End 00:00

Start

End

Will the sale of alcohol be for consumption?

- On the premises Off the premises Both

If the sale of alcohol is for consumption on the premises select on, if the sale of alcohol is for consumption away from the premises select off. If the sale of alcohol is for consumption on the premises and away from the premises select both.

State any seasonal variations.

For example (but not exclusively) where the activity will occur on additional days during the summer months.

The sale of alcohol to be allowed until 2.30am on Fridays & Saturdays with all customers vacated from the premises by 3am

Non-standard timings. Where the premises will be used for the supply of alcohol at different times from those listed above, list below.

For example (but not exclusively), where you wish the activity to go on longer on a particular day e.g. Christmas Eve.

Bank Holiday Sundays, Christmas Eve, Boxing Day, New years Eve & New Years Day if days fall on other days than Fridays and Saturdays. Sale of Alcohol to be allowed until 2.30am.

Continued from previous page...

Section 14 of 18**ADULT ENTERTAINMENT**

Highlight any adult entertainment or services, activities, or other entertainment or matters ancillary to the use of the premises that may give rise to concern in respect of children.

Provide information about anything intended to occur at the premises or ancillary to the use of the premises which may give rise to concern in respect of children, regardless of whether you intend children to have access to the premises, for example (but not exclusively) nudity or semi-nudity, films for restricted age groups etc gambling machines etc.

Section 15 of 18**HOURS PREMISES ARE OPEN TO THE PUBLIC****Standard Days And Timings**

MONDAY

Start End Start End

Provide timings in 24 hour clock (e.g., 16:00) and only give details for the days of the week when you intend the premises to be used for the activity.

TUESDAY

Start End Start End

WEDNESDAY

Start End Start End

THURSDAY

Start End Start End

FRIDAY

Start End Start End

SATURDAY

Start End Start End

Continued from previous page...

SUNDAY

Start

End

Start

End

State any seasonal variations.

For example (but not exclusively) where the activity will occur on additional days during the summer months.

Bank Holiday Sundays

Non standard timings. Where you intend to use the premises to be open to the members and guests at different times from those listed above, list below.

For example (but not exclusively), where you wish the activity to go on longer on a particular day e.g. Christmas Eve.

Christmas Eve, Boxing Day, New Years Eve, New Years Day

Identify those conditions currently imposed on the licence which you believe could be removed as a consequence of the proposed variation you are seeking.

Our Opening Times, Live Music/Recorded Music and Sale of Alcohol is currently set at 1am on Fridays and Saturdays. We'd like to extend our Live Music/Recorded Music to 2am. Extend the sale of alcohol to 2.30am and extend our closing time to 3am on Fridays, Saturdays & Bank Holidays.

- I have enclosed the premises licence
- I have enclosed the relevant part of the premises licence

Reasons why I have failed to enclose the premises licence or relevant part of premises licence.

Section 16 of 18

LICENSING OBJECTIVES

Describe the steps you intend to take to promote the four licensing objectives:

a) General – all four licensing objectives (b,c,d,e)

List here steps you will take to promote all four licensing objectives together.

we will stop live music/recorded music at 2am and give the customers and hour to wind down.

Continued from previous page...**b) The prevention of crime and disorder**

Door Staff are employed every fri/sat and will be extended to 3am to ensure safety of customers leaving the premises.
 No more customers will be allowed to enter the premises after 1.30am.
 CCTV system is installed and recording 24/7. & held for 31 days.
 Consumption of alcohol by customers at the premises must cease before the end of closing hours, staff will be required to collect all alcoholic drinks by 2.45am

c) Public safety

capacity will be reduced after 1am, any customers leaving will not be welcomed back in and no additional customers will be accepted.
 suitable risk assessments are in place.
 SIA door staff are employed to monitor the premises.
 manager/assistant manager will be on the premises at all times.
 licensable activities to be provided are Live music/DJ until am, then background music until 2am.
 Sufficient number of staff employed and on the premises at ll times.
 CCTV recorded and kept for 31 days.

d) The prevention of public nuisance

Door Staff will ensure all customers are dispersed from the premises in a quiet and respectful manner when leaving the premises also ensuring to respect neighboring properties.
 SIA Door Staff employed from until closing hours.

e) The protection of children from harm

no children are allowed on the premises.

Section 17 of 18**NOTES ON REGULATED ENTERTAINMENT**

Continued from previous page...

In terms of specific **regulated entertainments** please note that:

- Plays: no licence is required for performances between 08:00 and 23.00 on any day, provided that the audience does not exceed 500.
- Films: no licence is required for 'not-for-profit' film exhibition held in community premises between 08.00 and 23.00 on any day provided that the audience does not exceed 500 and the organiser (a) gets consent to the screening from a person who is responsible for the premises; and (b) ensures that each such screening abides by age classification ratings.
- Indoor sporting events: no licence is required for performances between 08.00 and 23.00 on any day, provided that the audience does not exceed 1000.
- Boxing or Wrestling Entertainment: no licence is required for a contest, exhibition or display of Greco-Roman wrestling, or freestyle wrestling between 08.00 and 23.00 on any day, provided that the audience does not exceed 1000. Combined fighting sports – defined as a contest, exhibition or display which combines boxing or wrestling with one or more martial arts – are licensable as a boxing or wrestling entertainment rather than an indoor sporting event.
- Live music: no licence permission is required for:
 - a performance of unamplified live music between 08.00 and 23.00 on any day, on any premises.
 - a performance of amplified live music between 08.00 and 23.00 on any day on premises authorised to sell alcohol for consumption on those premises, provided that the audience does not exceed 500.
 - a performance of amplified live music between 08.00 and 23.00 on any day, in a workplace that is not licensed to sell alcohol on those premises, provided that the audience does not exceed 500.
 - a performance of amplified live music between 08.00 and 23.00 on any day, in a church hall, village hall, community hall, or other similar community premises, that is not licensed by a premises licence to sell alcohol, provided that (a) the audience does not exceed 500, and (b) the organiser gets consent for the performance from a person who is responsible for the premises.
 - a performance of amplified live music between 08.00 and 23.00 on any day, at the non-residential premises of (i) a local authority, or (ii) a school, or (iii) a hospital, provided that (a) the audience does not exceed 500, and (b) the organiser gets consent for the performance on the relevant premises from: (i) the local authority concerned, or (ii) the school or (iii) the health care provider for the hospital.
- Recorded Music: no licence permission is required for:
 - any playing of recorded music between 08.00 and 23.00 on any day on premises authorised to sell alcohol for consumption on those premises, provided that the audience does not exceed 500.
 - any playing of recorded music between 08.00 and 23.00 on any day, in a church hall, village hall, community hall, or other similar community premises, that is not licensed by a premises licence to sell alcohol, provided that (a) the audience does not exceed 500, and (b) the organiser gets consent for the performance from a person who is responsible for the premises.
 - any playing of recorded music between 08.00 and 23.00 on any day, at the non-residential premises of (i) a local authority, or (ii) a school, or (iii) a hospital, provided that (a) the audience does not exceed 500, and (b) the organiser gets consent for the performance on the relevant premises from: (i) the local authority concerned, or (ii) the school proprietor or (iii) the health care provider for the hospital.

Continued from previous page...

- Dance: no licence is required for performances between 08.00 and 23.00 on any day, provided that the audience does not exceed 500. However, a performance which amounts to adult entertainment remains licensable.
- Cross activity exemptions: no licence is required between 08.00 and 23.00 on any day, with no limit on audience size for:
 - o any entertainment taking place on the premises of the local authority where the entertainment is provided by or on behalf of the local authority;
 - o any entertainment taking place on the hospital premises of the health care provider where the entertainment is provided by or on behalf of the health care provider;
 - o any entertainment taking place on the premises of the school where the entertainment is provided by or on behalf of the school proprietor; and
 - o any entertainment (excluding films and a boxing or wrestling entertainment) taking place at a travelling circus, provided that (a) it takes place within a moveable structure that accommodates the audience, and (b) that the travelling circus has not been located on the same site for more than 28 consecutive days.

Section 18 of 18**PAYMENT DETAILS**

This fee must be paid to the authority. If you complete the application online, you must pay it by debit or credit card. For detailed guidance on the fee structure, please refer to the table on Page 4, 5 and 6 of the guidance document.

* Fee amount (£)

315.00

ATTACHMENTS**AUTHORITY POSTAL ADDRESS****Address**

Building number or name

Street

District

City or town

County or administrative area

Postcode

Country

United Kingdom

DECLARATION

I/WE UNDERSTAND THAT IT IS AN OFFENCE, UNDER SECTION 158 OF THE LICENSING ACT 2003, TO MAKE A FALSE STATEMENT IN OR IN CONNECTION WITH THIS APPLICATION. THOSE WHO MAKE A FALSE STATEMENT MAY BE LIABLE ON SUMMARY CONVICTION TO A FINE OF ANY AMOUNT.

* I understand that I must now advertise my application.

* I understand that if I do not comply with the requirements my application will be rejected.

 Ticking this box indicates you have read and understood the above declaration

This section should be completed by the applicant, unless you answered "Yes" to the question "Are you an agent acting on behalf of the applicant?"

Continued from previous page...

* Full name

* Capacity

Date (dd/mm/yyyy)

* Full name

* Capacity

Date (dd/mm/yyyy)

Remove this signatory

Add another signatory

Once you're finished you need to do the following:

1. Save this form to your computer by clicking file/save as...

2. Go back to <https://www.gov.uk/apply-for-a-licence/premises-licence/carmarthenshire/change-1> to upload this file and continue with your application.

Don't forget to make sure you have all your supporting documentation to hand.

IT IS AN OFFENCE, UNDER SECTION 158 OF THE LICENSING ACT 2003, TO MAKE A FALSE STATEMENT IN OR IN CONNECTION WITH THIS APPLICATION. THOSE WHO MAKE A FALSE STATEMENT MAY BE LIABLE ON SUMMARY CONVICTION TO A FINE OF ANY AMOUNT.

Eich cyf / Your ref: Gofynner am / Please ask for: Emyr Jones
Fy nghyf / My ref: Llinell Uniongyrchol / Direct Line: (01267) 228717
Dyddiad / Date: 10th November 2021 E-bost / E-mail: publicprotection@carmarthenshire.gov.uk

Head of Homes and Safer Communities
Carmarthenshire County Council
3 Spilman Street,
Carmarthen
SA31 1LE

Dear Sir,

**RE: Application to Vary a Premises Licence
Clockwork Tavern, Unit 9, Eastgate, Llanelli, Carmarthenshire, SA15
3YF
Application Date 13/10/2021**

Further to the receipt of the above application, the Licensing Authority make the following representations:

a) Previous Enforcement Action / Prosecutions

The Premises were first licensed by the authority on the 14th of April 2011 when the Eastgate development was being constructed. The supporting documentation provided by the developer and applicant at that time set out their intentions for the complex and indicated that a terminal hour of 1am on Fridays and Saturdays as it was a restaurant dominated location. This licence was later surrendered once the occupiers of the individual units obtained their own premises licences.

The current premises licence which is held by Scarlet Regional Limited was granted in 2012 and also has a terminal hour of 1am. I attach a copy for information. An application was submitted by the licence holders on the 17th of August 2020 to place Mr Daniel Davies on to the licence as the designated premises supervisor.

There have been no previous prosecutions or enforcement action taken by the licensing authority under the Licensing Act 2003 in relation to these premises.

Following a COVID compliance visit on the 12th of September 2020 a Premises Improvement Notice was issued to the operator on the 14th of September 2020

Jonathan Morgan

Pennaeth Cartrefi a Chymunedau Mwy Diogel, Adran Cymunedau
3 Heol Spilman, Caerfyrddin, SA31 1LE Porth y Dwyrain, Llanelli, SA15 3YF
Neuadd y Dref, Heol Iscennen, Rhydaman, SA18 3BE

Head of Homes and Safer Communities, Department for Communities
3 Spilman Street, Carmarthen, SA31 1LE Eastgate, Llanelli, SA15 3YF
Town Hall, Iscennen Road, Ammanford, SA18 3BE



BUDDSODDWYR | INVESTORS
MEWN POBL | IN PEOPLE

Mae croeso i chi gysylltu â mi yn y Gymraeg neu'r Saesneg
You are welcome to contact me in Welsh or English

under the coronavirus regulations in force at that time. The notice was lifted on the 17th of September 2020 following the operator implementing the necessary improvements to comply with the regulations. Further advice regarding reducing the volume of background music was given by the COVID officers during a visit in November 2020.

b) Complaints.

The complaints received regarding the premises are listed below.

c) Responsible Authority Referrals.

The licensing authority has received a referral from the Environmental Health noise team in September 2021 regarding a complaint from a local resident relating to Music and People noise from the premises on Friday and Saturday nights between 10.30pm and 12.30am. In October 2021 we were made aware of a further noise complaint referred to Environmental Health by a company operating in a neighbouring building complaining about noise of live music from the premises until approximately 1.30am.

d) Relevant Sections of the Statutory Guidance.

The Licensing Authority believes that the following sections of the Statutory Guidance are relevant to this licence application: - Section 1 Introduction, Section 2 relating to The Licensing Objectives, Section 5 relating to Premises licences, Section 8 relating to Applications for Premises Licences and Section 10 relating to Licence Conditions.

e) Relevant Sections of the Local Licensing Policy.

The Licensing Authority believes that the following sections of Carmarthenshire's Licensing Policy are relevant to this licence application:- Section 3 Fundamental principles, Section 4 Conditions of Licence, Sections 5 – 9 relating to The Licensing Objectives and Section 11 relating to Licensing Hours and in particular :-

11.1 The Licensing Authority recognises that fixed and artificially early closing times in certain areas can lead to peaks of disorder and disturbance on the streets when large numbers of people tend to leave licensed premises at the same time. Longer licensing hours may therefore be an important factor in reducing friction at late night food outlets, taxi ranks and other sources of transport in areas where there have already been incidents of disorder and disturbance.

11.2 However, the Licensing Authority recognises that in certain cases, the presumed benefits of longer licensing hours may be outweighed by the disadvantages of increased public nuisance, crime and disorder. This may be particularly the case in rural or residential areas. The Licensing Authority advises applicants to address this possibility when preparing their operating schedules in accordance with section 5 of this policy.

11.3 As far as the Licensing Authority's overall approach to licensing hours is concerned, it has not introduced any form of zoning at present.

11.4 Instead, regard will be given to the individual characteristics of the premises concerned and the area in which it is located. It is recognised that pubs, nightclubs, restaurants, hotels, theatres, members' clubs and community venues all contribute to the night time economy but with contrasting styles and characteristics. Proper regard will be had to those differences and the impact they are likely to have on the local community.

11.5 Premises licensed to sell alcohol will generally be permitted to do so during the normal hours they intend to open for business

11.6 Where representations are received, the Licensing Authority will deal with the issue of licensing hours on the individual merits of each application. For example, when issuing a licence, stricter controls may be imposed in the case of premises which are situated in the vicinity of residential accommodation.

f) Proposed Operating Schedule.

Having considered the current application and the operating schedule put forward by the applicant, the Licensing Authority believes that, if the application were granted, the wording set out in the operating schedule, which refers to the existing licence conditions, is not sufficiently precise to enable it to form clear enforceable licence conditions in accordance with section 18(2)(a) of the Licensing Act.

Given the location of the premises, along with the requested extension in permitted hours by two hours until 3.00 am on Friday and Saturday nights as well as the activities sought in the application and the existing complaints, the licensing authority believes that it would be appropriate for the applicant to provide an assessment as set out in Section 5 of the Licensing Policy:-

5.1 Applicants for new premises licences and those seeking variation of existing licences/permissions are advised to demonstrate how they intend to promote the four licensing objectives.

5.2 In order to do this, applicants are advised to carry out a comprehensive and detailed assessment which should cover, amongst other things:

- a) The scope and nature of the licensable activities to be carried out.
- b) The duration of such activities.
- c) The nature and location of the premises in which the activities are to take place (this may include reference to beer gardens, smoking shelters or any other open areas forming part of the premises, or used by the premises for the carrying on of licensable activities and/or consumption of alcohol).
- d) The nature and location of other premises in the vicinity, and their occupants.
- e) The skills and knowledge levels of persons engaged in carrying out those activities.

5.3 The Licensing Authority advises that such an assessment should identify issues which could lead to the licensing objectives being undermined.

5.4 The Licensing Authority advises that such an assessment, and its conclusions, be incorporated within, or be annexed to, the operating schedule,

which forms part of the application. Where an applicant chooses not to submit a risk assessment, they are advised instead to provide a statement explaining why, in their opinion one is not needed.

5.5 The Licensing Authority advises that the operating schedule sets out in detail the control measures the applicant intends to put in place to deal with the risks identified in the assessment

Following a meeting at the premises with the operator on the 8th of November to discuss the application, the licensing authority requests that the control measures outlined verbally at the meeting be included within the requested written assessment.

From experience of dealing with alcohol licensed premises operating at the times proposed within the application, in a town centre location where customers move between various licensed premises forming part of the night time economy the licence holders will need to have robust systems in place in order to promote the licensing objectives.

Even with such systems in place, the operator will have limited ability to influence the behaviour of customers arriving and leaving the premises as well as any other individuals attracted to the premises during the extended hours requested.

The Police and Environmental Health Section have both submitted letters of representation in relation to the application. The Police representation requests that additional conditions be attached to the licence should the application be granted. The Environmental Health Section representation dated the 22nd of October 2021 also requests that the applicant provides additional information on how they intend to promote the "Prevention of Public Nuisance" and "Public Safety" Licensing Objectives. The Environmental Health Section has submitted a further representation on the 10th of November 2021 indicating that in the absence of the requested information they object to the application. However, they also indicate that they may re-consider their position if the requested information is provided.

Further representations have been received from other parties, objecting to the granting of the application. The subcommittee will have to consider those representations as well as the representations of the responsible authorities and be satisfied that granting the application will not undermine the licensing objectives.

If the application is granted, I believe it would be appropriate to attach the conditions requested by the Police to the premises licence.

These representations have been prepared on the 10th of November with the benefit of viewing the original application and representations listed above.

I would be grateful if the applicant could forward the requested information and contact me to discuss the above representations at the earliest opportunity and certainly prior to the application being referred to a Licensing Sub Committee hearing for determination.

BS

If you require any further information or assistance, please do not hesitate to contact me.

Yours faithfully,

Emyr Jones
Licensing Lead

Eich cyf / Your ref:

Fy nghyf / My ref: AWM

Dyddiad / Date: 22/10/2021

Gofynner am / Please ask for:

Llinell Uniongyrchol / Direct Line:

E-bost / E-mail:

Aled Morgan

01269 598262

PublicProtection@carmarthenshire.gov.uk

Scarlets Regional Limited
Parc Y Scarlets
Parc Pemberton
Llanelli
Carmarthenshire
SA14 9UZ

Dear Sir/Madam,

**Re: Application to Vary Premises Licence
Clockwork Tavern, Unit 9, Eastgate, Llanelli, Carmarthenshire, SA15 3YF**

Further to the receipt of the above application, I would like to make the following representations on behalf of the Environmental Health Section of Carmarthenshire County Council.

The premises currently operates as a Licensed Premise, therefore we do have some history of "Public Nuisance" or "Public Safety" related issues relating to the operation of the premise. Therefore I would like to make the following comments which are based on my professional opinion, my experience from dealing with similar venues and the following factors relating to this application

- The nature of the application including the hours and activities applied for
- The proximity to residential properties and noise sensitive businesses
- The proposed operating schedule is not clear in specifying what control measures will be employed to ensure the promotion of the "Prevention of Public Nuisance" Licensing Objective.
- History of ongoing noise complaints from the premises

Given the above factors, I recommend the applicant should provide further information on how they intend to promote the "Prevention of Public Nuisance" and "Public Safety" Licensing Objectives. This information would hopefully assist me in making an informed decision as to whether or not appropriate conditions are necessary for this application.

If you wish to discuss the matter further, please do not hesitate to contact me.

Yours Faithfully

Mr A W Morgan
Environmental Health Practitioner
Environmental Health Section

Robin Staines BA (Hons.), MA, MCIH

C2

From: Aled Morgan <AWMorgan@carmarthenshire.gov.uk>
Sent: 10 November 2021 14:24
To: SCH Licensing <SCHLicensing@carmarthenshire.gov.uk>
Subject: RE: Premises Variation: Clockwork Tavern.

Good Afternoon,

Further to the receipt of the above application, and my representations dated 15/10/2021 may I provide you with the following update. I have not received the information requested. Also I've not had an opportunity to undertake an out of hours assessment of the noise levels which was discussed during my site visit with the applicant on the 2nd of November 2021.

Therefore based on the above and with the information to hand at this moment in time the Environmental Health Section objects to the above application. Should further information be provided or gathered in due course we may reconsider our position with respect to this application.

I trust that the above is of some information , should you have any queries or concerns then please do not hesitate to contact me.

Diolch

Aled Morgan
Arweinydd (Dros dro) Tîm Llygredd / Temp Pollution Team Lead
Swyddog Iechyd yr Amgylchedd / Environmental Health Officer

D1



Heddlu Police
**DYFED
POWYS**

David Bizby
Divisional Licensing Officer
101 extension 27464
David.Bizby@dyfed-powys.pnn.police.uk
PRG747/DB

Scarlets Regional Limited
Parc Y Scarlets
Parc Pemberton
Llanelli
Carmarthenshire
SA14 9UZ

10 November 2021

Dear Sir/Madam,

Re: Variation of a Premises Licence – Clockwork Tavern, Unit 9, Eastgate,
Llanelli, Carmarthenshire. SA15 3YF

Variation Details: application to increase the hours for recorded music Sunday
to Thursday 08:00-00:00; Friday & Saturday 08:00-02:00:
Sale of alcohol Sunday to Thursday 08:00-00:00; Friday & Saturday 08:00-
02:30.

Date completed application received – 13/10/2021

With reference to the above application for the grant of additional hours of
recorded music and sale of alcohol, I can confirm that I have been liaising
closely with colleagues in the Llanelli Neighbourhood Policing Team in
Llanelli.

Initially, the Eastgate area was developed as a family and entertainment
venue and not as a late-night drinking area.



www.dyfed-powys.police.uk

Prif Gwnstabl Dros Dro Temporary Chief Constable Claire Parmenter
Pencadlys Heddlu, Blwch SB 99, Llangynnwr, Caerfyrddin. SA31 2PF
Police Headquarters, PO BOX 99, Llangunor, Carmarthen. SA31 2PF

Mae Heddlu Dyfed-Powys yn croesawu gohebiaeth yn Gymraeg a Saesneg. Byddwn ni'n sicrhau ein bod ni'n ymateb yn eich dewis
iaith ac ni fydd oedi mewn perthynas ag unrhyw ohebiaeth drwy'r Gymraeg.
Dyfed-Powys Police welcomes correspondence in Welsh and in English, and we will ensure that we respond to any
correspondence through the language of your choice. Corresponding via the medium of Welsh will not endure any delay.



Police Sergeant Ben Ashton who runs the Neighbourhood Policing Team states that historically, there were problems in the area late at night especially due to noise pollution. When he commenced in Llanelli with Tom Peppers and Bar Luna being late night attractions, the area was always busy with drunk people shouting and fighting or just being jovial but loud during the late and early hours.

Sergeant Ashton will state that, "Opening the bar for longer will increase the persons drunken state which would see a return to late night drunk activities and the issues for residents which were evidenced in the past". PS Ashton draws attention to other venues within Carmarthenshire that have late licences and although they are positioned in different locations they have required heavy intervention from both the Police and the Council to manage the way their patrons behave. He does not expect this premises to be any different from any other establishment.

An extra 1.5hrs of drinking will mean the establishment will be responsible for making people more drunk and later into the evening. This will indeed create increased demand for the police service and other emergency services.

In terms of mitigation, Mr Davies is willing to add a double door to assist with noise but that does not mitigate the noise his customers will make when they leave the property. The wind breaks could be used to direct revelers away from the property but this is at the good will of the patrons leaving following a suggestion. An intoxicated person generally becomes less reasonable.

PS Ashton adds that his views are not to object to this application, however he believes that careful consideration should be given to it.

The Police therefore ask for strong and robust conditions to promote the Licensing Objectives and make the following representations:

1. A CCTV system shall be maintained at the premises which gives coverage to the whole of the premises including entry and exit points as well as all consumption and smoking areas used by customers. There must not be any hidden or obscured areas or any other obstruction including outside Umbrellas and Canopies.
2. The system shall continually record whilst the premises are open and conducting licensable activities and if a defect arises the Licensing Authority or the Police must be informed and immediate arrangements must be made to rectify the fault
3. Footage from the CCTV system must be capable of being recorded onto an easily downloadable format.
4. Images recorded by the CCTV system shall be retained for a period of not less than 31 days and shall be provided to the Police or an authorised Officer of the Licensing Authority upon request.

5. All images recorded by the CCTV system shall denote an accurate date and time.
6. The challenge 25 scheme to be adopted at the premises with notices and posters to be clearly displayed in the premises, near the entrances and bar areas. This is to emphasize to customers that they will be challenged if they look 25 or under and they shall provide documented proof that they are over 18 years of age. Proof of age shall only comprise a passport, photo card driving licence, an EU/EEA national ID card or similar document, an HM Forces warrant card, or a card bearing the PASS hologram.
7. Notices shall be prominently displayed indicating that the area is being monitored by CCTV.
8. Notices shall be prominently displayed requesting customers to respect the needs of local residents and use the area quietly.
9. No person under the age of 18 shall be employed on the premises whether paid or unpaid for the purpose of serving alcohol.
10. A minimum of 3 Door Supervisors to be on duty from 2200hrs on Friday and Saturday nights until the premises close.
11. A minimum of 3 Door Supervisors to be on duty from 22.00hrs on specific days such as Boxing Day, New Year's Eve and Bank Holiday Sundays. Also whenever regulated entertainment events take place.
12. When employed, Door Supervisors must be registered with the SIA and to be on duty until the time that all members of the public have left the premises.
13. The challenge 25 scheme to be adopted at the premises with notices and posters to be clearly displayed in the premises, near the entrances and bar areas. This is to emphasize to customers that they will be challenged if they look 25 or under and they shall provide documented proof that they are over 18 years of age. Proof of age shall only comprise a passport, photo card driving licence, an EU/EEA national ID card or similar document, an HM Forces warrant card, or a card bearing the PASS hologram.
14. The Designated Premises Supervisor or another Personal Licence Holder to be on the premises on Friday and Saturday nights between the hours of 20.00 and the end of permitted hours.
15. The terminal hour to the outside area in front of the premises to be 22:30 hours Monday to Sunday for the consumption of alcohol. Customers permitted to temporarily leave and then re-enter the internal

D4

area of the premises, eg. to smoke, after 22:30 hours shall not be permitted to take drinks or open containers with them.

16. Outside tables and chairs shall be rendered unusable by 22:30 hours each day and shall be removed from the outside area by 22:30 hours each day.

I also refer to 5.6 of the Licensing Policy whereby the Licensing Authority believes that the effective management of licensed premises by suitably experienced and trained staff is essential for the promotion of the four licensing objectives. This is especially relevant to the management of outdoor areas and to this application.

The Police believe that the above conditions are necessary and appropriate to promote the Licensing Objectives.

Yours Sincerely,

David Bizby
Divisional Licensing Officer

cc. Mr EOR Jones,
Licensing Lead,
Carmarthenshire County Council,
3 Spilman Street,
Carmarthen,
SA31 1LE

E1

From: Cllr. Eryl Morgan <EMorgan@carmarthenshire.gov.uk>

Sent: 31 October 2021 10:57

To: Andrew Rees <RARees@carmarthenshire.gov.uk>

Subject: RE: nightclub

Andrew,

I endorse Mr Thomas's view and concerns that will undoubtedly arise if this application is granted. The bus shelters in the bus station will be an attraction to people going to and leaving the Clockwork Tavern. History of behaviour problems in the past in the area will undoubtedly arise again, for example noise, urinating, and taxi arriving and departing will have a serious negative impact on the residents of Stepney Place. As the area is part of my Ward I strongly oppose this application.

Cllr Eryl Morgan.

E2 .

From: jeff thomas

Sent: 25 October 2021 17:36

To: Public Protection <publicprotection@carmarthenshire.gov.uk>

Subject: Clockwork Pub, Eastgate, Llanelli.

Dear Sir/ Madam,

I am writing regarding a matter that concerns me and will also impact on my neighbours. There is currently a pub in the Eastgate development (Clockwork), they have applied to become a nightclub with a 3am license. This will be problematic for us as neighbours and for the neighbouring properties. It will definitely detract from customers wanting to frequent the theatre and Odean in the evenings.

some of our concerns are:

- *There is no smoking area for this property and they will no doubt congregate outside the front causing noise etc. into the early hours.
- *We will have to endure the comings and goings til 4am
- *Taxis etc until 4am
- *Anti social behaviour which we have endured for years from Tom Peppers
- *Damage to the bus stops and urinating in the streets.
- *Damage to our properties.

The Eastgate development was meant to be an early evening family development. In the meeting I attended (prior to the development) there was no mention of a nightclub or late night licenses.

We have endured YEARS of problems from Tom Peppers/Moonraker we have had things through our letter boxes, fights in the streets, broken windows, amongst other incidents that I'm sure you as the local authority are aware of, but in fairness to that place, it was there when we bought our house, although the entire area has been altered and now we face directly onto the place causing us extra grief. I can assure you that ALL my neighbours are against this application.

I include the link to the application.

<https://www.carmarthenshire.gov.wales/media/1226704/clockwork-tavern.pdf>

Yours,

Jeff Thomas
Stepney Place

1. Sent: 31 October 2021 15:56

To: Public Protection <PublicProtection@cararthenshire.gov.uk>

Subject: An Appeal Against The Clockwork Tavern's Application For Variation of a Premises Licence

Dear Sir/Madam,

I wish to appeal against the above application made by The Clockwork Tavern (owned by Scarlets Regional Ltd) and I attach a letter detailing the nature of my complaint.

Please feel free to ask me any questions.

Thank you in advance.

Best wishes,

Stepney Place Resident

A Letter Of Appeal Against The Clockwork Tavern's Proposal To Extend Its Licencing Hours To 03:00am On Friday And Saturday

31 October 2021

To whom it may concern,

I would like to appeal against The Clockwork Tavern's Application For Variation Of A Premises Licence. The above establishment, located in Llanelli's Eastgate complex, wishes to extend its opening hours to 08:00-03:00 on Friday and Saturday (it is currently 08:00-01:00) and 08:00-00:00 (12 midnight) on Sunday to Thursday (currently 08:00-23:00). I sincerely hope that this application is NOT granted for the reasons below.

The Clockwork Tavern has been constantly playing loud music until 1am (sometimes even later – contrary to the licencing law) on Friday and Saturday since it reopened after lockdown on Friday 6 August 2021. This is exacerbated by the fact that the doors of the bar are continuously opened by customers, going in and out of the bar for a cigarette break. Thus, besides the incessant beat of the music, boisterous shouting and screaming can also be heard from myself and the other residents of Stepney Place, which is merely 80 metres away from the Clockwork Tavern. Since there is not any kind of sound barrier to block out this anti-social noise pollution, it is really difficult to sleep at night, especially on Friday, Saturday and sometimes on a Sunday night. I have even had to resort to wearing ear plugs in order just to get a good night's sleep, but even then I can still hear the constant beat of the loud music until it is eventually switched off at 1am! However, illegally it must be said, the music did not stop until 2:15am in the early hours of Sunday 31 October 2021, which was when the bar's doormen eventually closed the doors (please note that the current closing time is supposed to be

E4

1am). Similarly, in the early hours of Monday 25 October, the music did not stop until 1am (again, according to The Clockwork Tavern's current licence, the music should have stopped at 11pm). Inevitably, I lost valuable sleep on this particular night, which had a profound effect on my work the following day and my mental health in general. Everybody has the right to sleep in peace.

Another reason why I do not wish for the above application to be granted is the anti-social behaviour associated with the establishment. Every weekend, I witness at least one fight between customers of the Clockwork outside its entrance, and the police have been called to deal with such skirmishes on several occasions since August. I know that excessive alcohol consumption and a temper are a dangerous combination, so extending the opening hours will inevitably lead to more anti-social behaviour. In addition to the violence, I have also witnessed many Clockwork customers stumble out of the bar and then urinate inside the bus shelters and on the wall of the nearby Odeon cinema.

Although I object to the Clockwork Tavern's wish to extend the licencing hours, I do not wish for the establishment to be closed down full stop. Indeed, I have been there several times myself when it was under previous ownership and a much more pleasant experience. Therefore, I am willing to make a compromise. I would like to suggest that the licensing hours remain at 08:00-23:00 on Sunday to Thursday, and are changed to 08:00-00:30 (12:30am) on Friday and Saturday. I think that this is a very reasonable request considering the above anti-social behaviour which I and other residents have to endure because of The Clockwork Tavern.

I sincerely hope that my request is listened to and fulfilled.

Thank you in advance.

Yours faithfully,

Stepney Place, Llanelli resident

ES

From:

Sent: 31 October 2021 18:27

To: Public Protection <PublicProtection@carmarthenshire.gov.uk>

Subject: Letter of Complaint Against The Clockwork Tavern's Application For Variation of a Premise Licence

Dear Sir/Madam,

Please find attached a letter concerning the above issue.

I look forward to your response.

Best wishes,

Stepney Place Resident

TO WHOM IT MAY CONCERN

Re: APPLICATION TO VARY A PREMISES LICENCE AT CLOCKWORK TAVERN,
EASTGATE, LLANELLI – PRIVATE LTD COMPANY OF SCARLETS REGIONAL
LTD

I am a resident of Stepney Place, Llanelli, and live across the road from the Clockwork. Since the beginning of August 2021, the residents have been complaining about the loud music emanating from the pub, big crowds outside shouting, screaming, urinating in the bus shelters and Odeon cinema doorway and generally unsociable behaviour. Police have been called on numerous occasions to break up brawls.

Usually, a big crowd congregates outside throughout the evening, especially Saturday night, apparently for a cigarette break but to me its just to carry on the party outside. Doors which should be kept closed and monitored by the staff are kept open and the loud music is thumping away in the early hours past 1am, keeping us awake and in a state of great tension.

The Noise App has been used by the residents and should be available for your perusal, as well as documented records.

We only knew that the pub had asked for a 3am licence as we had been in contact with the Licensing Authority. Notification had not been sent to us advising that the anti-social hours and behaviour was now going to extend further. This is a residential street and a night club should not be in the vicinity.

Eastgate is supposed to be family-friendly but the Clockwork has managed to change that. Licensing hours should be reduced to at lease 12 midnight in keeping with other establishments in the area. Hungry Horse and Nandos are a good example of family-orientated business,

Clockwork is just a noisy pub with no concern for the residents' peace of mind and a good night's sleep.

Travel Lodge has also made complaints as guests cannot sleep. Please view Trip Advisor.

There is also a rumour that they intend to open the upstairs as a nightclub. More people, more noise, 300-400 bodies. The pub is open Saturday until 1am – this has crept up from 12am previously and has opened lately on Sunday on at least two occasions until past 1am, which is over their licensing hours.

I was told by the manager, "Do you know what's coming here? This is going to be the hub of Llanelli." More pubs! Brilliant! What we need is more shops to bring people into the town centre, not drinking places which only bring money in for the owners and not the town. Also he added, "You'll never close us" (not that I said that) "the Scarlets lease this building." Whatever did he mean by that?

The council would be loathe to close the place down as there are so many empty units in Eastgate at the moment and it would be a great loss of income for them. So please compromise, reduce the late hours and put this noisy pub out of a residents' area for the residents' peace of mind. My health is suffering due to lack of sleep and wondering what delights Friday and Saturday hold and now Sunday is in the offing. I wonder if the owners, manager, live in a nice quiet place?

The manager has advised that tickets for 100 people are being sold for every weekend in December so he already thinks this application for a 3am extension is a "Done Deal". Is he jumping the gun or does he know something we don't?

3am kicking out time is a nightclub time. Eastgate, when in the process of construction, was referred to as a family-friendly place – families are tucked up in bed at 3am not screeching and listening to thumping noise!

Its time to think of the people living in Stepney Place and not for a business who cares nothing for the residents and whose only priority is cramming in as many people as they can to make money and noise.

NIGHTCLUBS SHOULD NOT BE IN RESIDENTIAL AREAS.....

I sincerely hope you listen and fulfil my request.

From: Matthew

Sent: 01 November 2021 09:13

To: Cllr. Jeff Edmunds <jedmunds@ Carmarthenshire.gov.uk>; Public Protection <publicprotection@ Carmarthenshire.gov.uk>

Subject: Proposed license change requested by the clockwork tavern

To whom it may concern,

I've just been made aware of this by one of my neighbors on Stepney Place (Llanelli).

I would like to voice my concerns into this as surely a public discussion should have taken place, as a resident I can confirm that I've not had any letter, email or other invitation to a public discussion on this. I can also confirm that no notifications have been placed on nearby signage as they have been with the speed bumps installed on nearby roads.

When the Eastgate complex was constructed we had an agreement in place that noise would be limited to no later than 1am, are we seeing the council side with disruptive businesses rather than those who live in the area? I'm sure the owner is claiming to bring life back into the area but surely there are better located establishments that would be considerably less disruptive. No doubt the owner is claiming to be bringing jobs into the area, safe to say they probably pay minimum wage rather than living wage so the only wealth coming in would be for the owner rather than employees. So far after speaking with my neighbors I get the impression that the owner has the approach of I don't care, this is what I'm doing approach rather than listening to locals, understanding the complaints and developing a dialog as to how he will reduce the noise & public disorder this extended license will no likely create.

Has anyone been in touch with the police force to determine how many complaints of noise & public disorder complaints there have been? Its also rather convenient that the application is mad this time of the year when the doors are likely to be closed aside those coming in & out of the venue and those popping outside for a cigarette. Will the owner ensure that he is talking personal responsibility for littering caused by smokers? What is the anticipated noise generated by the club with the doors open? As we move into warmer pashe year those doors will be open allowing more noise pollution to be generated? How is the owner going to counter this?

I would be very curious to see the application so would appreciate either being sent an electronic version or directed to an online link to the application. Should be very enlightening to see how the owner plans to deal with the noise created at that hour in the morning. I'm sure he's dealt with all aspects of HSE & noise, not just for the local residents but also for his employees... Has he???

I'm also at a loss as to where the owner will put 400 people? The venue isn't that big, is it expanding? With the UK still being impacted by covid another concern is

E8

the venue acting as a petri dish for viruses like covid to mutate into something that could cause a serious impact to the local area and beyond. I for one really do not want to see a 'Llanelli variant' of covid. That would be seriously embarrassing for the town and the council as a whole.

Regards

Matt
Stepney Place Resident

E9.

Stepney Place

Liamell

SA/S/SE

Dear Sir,

We are writing to object to the proposed extended hours of the Clockwork Tavern to 2.30 A.M at week-ends. We have constantly complained to the council and the police about the loud music and people congregating outside for cigarette breaks. We have double glazing but can still hear the music + loud noise coming from inside + outside the pub. We are after all a residential area and is not the place for a proposed Nightclub - We have already had the police there breaking up fights between men + women.

We will also have to put up with cars + taxis + and possibly minibuses pulling up all ~~hours~~ hours with doors

Slamming and Horns blowing with
people kicking and urinating in the
bus shelters. We've also heard
that the customers in the Travel
Lodge running along side the pub
have also complained about
disturbed sleep due to the noise
if this proposal goes ahead it
could ~~also~~ also affect our mental
health as we would not know what
to expect from one weekend
to the next

yours sincerely

Mr Gareth Thomas

Mrs Jane Turner

Public protection
3 Spilman street
Carmarthen
SA31 1LE

November 4th 2021

Dear Sir/Madam,

I have attached my objection to the Nightclub extension on Clockwork Pub, Eastgate, Llanelli. Which is 50mtrs from residential houses.

As you will see from my objection I have some knowledge of licensing, and base my objections on the 4 licensing objectives. I hope the Police are able to provide the number of calls received in that area over the last few years as this will be relevant.

Yours Faithfully,

P.Brookfield.

Dear Sir/Madam

To whom it may concern,

I would like to object and raise concerns to the application by the Clockwork Tavern to extend their license until 3am.

My objection is based on the following points of fact:

Firstly:

The application itself is completely unworkable and has lots of contradictions throughout. I have listed and detailed them.

I don't think that any of the 4 Licensing objectives can be achieved, the entire application contradicts itself and goes to show the problems the operator will have in trying to operate the venue. There is also clearly no experience in operating this kind of premises.

I have made some observations for concerns on the application:

General

"Live music to stop at 2am and give the customers an hour to wind down", however in section 11/18 it says from 1am - 2am the music will be background level. In section (c) *Public safety* it says "background music until 2am". Which is it?

This is the first contradiction under the licensing objectives. This clearly shows inexperience and that the operator does not have a clear operating plan.

The prevention of public nuisance

“Door Staff will ensure all customers are dispersed from the premises in a quiet and respectful manner when leaving the premises” Firstly this will be impossible, the definition of ensure is to “Make certain”. How can Door Staff make certain customers under the influence of alcohol are; quiet, respectful and well-behaved?

This shows clear inexperience in the nightlife industry. Also the operator under The prevention of public nuisance states “SIA Door Staff employed from to closing hours”. The operator has not included a start time for door staff. This therefore leaves a lot of nearby establishments vulnerable to intoxicated people potentially harassing their customers or damaging their property, as the operators opening time could be for many hours before their Door Staff start. In addition, the East Gate is a modern and established family location and was not designed to have a night club premises near. This will undoubtedly cause distress to neighbours, and business in the area in terms of noise, general nuisance and damage to property. For example people under the influence waiting by neighbouring houses for taxis at 3:30/4am.

Public safety

Also under public safety, the operator states that there will be no entry for new customers and no re-entry after 1am. However under the prevention of crime and disorder the operator states “No more customers will be allowed to enter the premises after 1:30am.” This is yet another contradiction in the licensing objectives. This will also be very difficult to manage as it is assumed that once people are told there is no re-entry they will leave quietly, which from experience, is never the case. There is also no plan for people who smoke, as The Clockwork Tavern does not have a smoking shelter, will someone who wants a cigarette be allowed to re-enter?

Protection of Children from harm

“no children are allowed on the premises”. To start with, The Clockwork Tavern is advertising online offering children parties, and advertising family Sunday lunch. This completely contradicts the application of trying to become an adult late night venue. I highly doubt that they will cancel all booked Christmas parties and private venues with any children coming and only allow bookings for people 18+.

As mentioned above, the premises does not have a smoking area, so where will the customers smoke. As The Clockwork Tavern was designed to be a shop. There is no plan on how the operator intends to control the noise of possibly up to 100 people smoking outside. This premises is not suitable for this operation and was never intended to operate as a Nightclub. Even with a lobby system the glass fronted windows are single glazed and designed for a shop.

The applicants only have another 12 months on their lease, therefore if a late night license is granted to this applicant, a future tenant of The Clockwork Tavern might want to operate as a nightclub all day, 7 days a week in the centre of a family development. I really think this would blight the future of this unit, and devalue the Eastgate development as a whole.

Secondly: As a resident of Llanelli all my life and having seen the demise of our town, like others, over the past years the Eastgate was welcomed and brought big names to the town, I believe this application would put that under threat as this premises is opposite the main town centre hotel, Travel Lodge, a business which was coveted and championed as an anchor in the Eastgate development, I have attach some reviews from trip advisor relating to the Clockwork Tavern, which currently does not have a license till 3am. As a Llanelli resident I welcome new business into the town, but it would be an absolute disaster for the town centre if the travel lodge were to leave and I urge this to be considered.

Perry R wrote a review Sept 2021

Ruined Weekend

DO NOT BOOK THIS HOTEL. Not if you actually want to get some sleep. All the rooms in the hotel are on the first floor of a fairly modern building, however, on the ground floor along with various shops are two pubs. Unfortunately the family rooms one of which we were in are located directly above one of the pubs. On the Friday of our stay a live band were playing untill about 12.30 am, sadly when they finished the pub carried on playing music over the sound system untill 02.00am. This wasn't the kind of distant thud you might expect from a car stereo, the band may as well have been in our room. When the music finally stopped we had to listen to the venues patrons for another half an hour slowly making their way out. There wasn't a band on the Saturday night but it wasn't much...

Central but too noisy wrote a review August 2021

Our stay in a family room was spoilt by the very loud noise pollution coming from a local drinking establishment which blasted through our room until well after midnight on Saturday night. Sunday night was quiet but Monday morning the bin collection of the businesses surrounding the hotel woke us up before 6am.

Noisy weekend stay.

The noise level heard from within the family room from the Clockwork Tavern 4 floors down at ground level across the road was pretty relentless during our Saturday night stay. The bass was strong and it was loud enough that we could even make out most of the songs. When discussed with the reception they said it would stop by 11pm, however it actually went on until they closed at 1am. Far from ideal when I had to be up for 6.30am the following morning.

Please be aware these are 3 of many examples on trip advisor alone.

Thirdly: When the Eastgate development was proposed I attended meetings with other town centre residents and businesses, I was assured by Mark James (Chief Executive) and Jonathon Fearn, that this would not be a late night area and was to be a family and evening development closing at 1am and would compliment the Ffwrnes theatre and Odeon. A 3am nightclub will greatly have a damaging affect on those businesses and would most certainly discourage families and elderly customers from the development, which is whom the development is trying to attract. Have the residents on Stepney Place been consulted? and I doubt any of them would approve of this license being granted. Have local Council members been informed? This area was also designated a "hot spot" of anti social behaviour by the Police and Local authority a few years ago, I therefore strongly believe that adding another nightclub will be detrimental to the area and local community.

PREMISES LICENCE LICENSING ACT 2003

Premises licence number

No: OONU-PRM-01119

Part 1 - Premises details

Postal address of premises, or if none, ordnance survey map reference or description

Address

**Clockwork Tavern
Eastgate
Llanelli
Carmarthenshire
SA15 3YF**

Telephone number

Where the licence is time limited the dates

This Premises Licence is not time limited.

Licensable activities authorised by the licence

- **Sale by retail of alcohol.**
- **Regulated Entertainment (As specified overleaf).**
- **Late night refreshment.**

The above activities may only be conducted within the areas of the premises licensed for those specific activities, as shown on the plan attached to this licence as Annex 4.

**The Times The Licence Authorises The Carrying Out Of
Licensable Activities**

Supply of alcohol

Standard days and timings

**Sunday to Thursday 08:00 - 00:00
Friday & Saturday 08:00 - 01:00**

Non Standard timings.

During international sporting events which fall outside our standard hours, we shall sell alcohol half an hour before the event starts until half an hour after the event finishes.

Films

Standard days and timings

**Sunday to Thursday 08:00 - 00:00
Friday & Saturday 08:00 - 01:00**

Indoors in the areas licensed at the premises for this activity.

Non Standard timings

The option to open 30 minutes before and 30 minutes after, for any major international sporting event that is televised.

Live Music

Standard days and timings

**Sunday to Thursday 08:00 - 00:00
Friday & Saturday 08:00 - 01:00**

Indoors in the areas licensed at the premises for this activity.

Recorded Music

Standard days and timings

**Sunday to Thursday 08:00 - 00:00
Friday & Saturday 08:00 - 01:00**

Indoors in the areas licensed at the premises for this activity.

Performance of dance

Standard days and timings

**Sunday to Thursday 08:00 - 00:00
Friday & Saturday 08:00 - 01:00**

Indoors in the areas licensed at the premises for this activity.

Anything of a similar description to live music, recorded music or performances of dance

Standard days and timings

**Sunday to Thursday 08:00 - 00:00
Friday & Saturday 08:00 - 01:00**

Indoors in the areas licensed at the premises for this activity.

Provision of facilities for making music

Standard days and timings

**Sunday to Thursday 08:00 - 00:00
Friday & Saturday 08:00 - 01:00**

Indoors in the areas licensed at the premises for this activity.

Provision of facilities for dancing

Standard days and timings

**Sunday to Thursday 08:00 - 00:00
Friday & Saturday 08:00 - 01:00**

Indoors in the areas licensed at the premises for this activity.

Provision of facilities for entertainment of a similar description to making music or dancing

Standard days and timings

**Sunday to Thursday 08:00 - 00:00
Friday & Saturday 08:00 - 01:00**

Indoors in the areas licensed at the premises for this activity.

Late Night Refreshment

Standard days and timings

**Sunday to Thursday 23:00 - 00:00
Friday & Saturday 23:00 - 01:00**

Indoors in the areas licensed at the premises for this activity.

The opening hours of the premises**Standard days and timings**

**Sunday to Thursday 08:00 - 00:00
Friday & Saturday 08:00 - 01:00**

Non Standard timings.

During international sporting events which fall outside our standard hours, we shall open half an hour before the event starts until half an hour after the event finishes.

In relation to the morning on which summertime begins, where the terminal hour specified in the licence is 1am or later, it shall be extended by one hour.

Where the licence authorises supplies of alcohol whether these are on and/or off supplies

This premises licence authorises the supply of alcohol for consumption both on and off the premises.

Part 2

Name, (registered) address, telephone number and email (where relevant) of holder of premises licence

Name: Scarlets Regional Limited

**Address: Parc Y Scarlets
Parc Pemberton
Llanelli
Carmarthenshire
SA14 9UZ**

Telephone number: 01554 783900

Email:

Registered number of holder, for example company number, charity number (where applicable)

03389199

Name, address and telephone number of designated premises supervisor where the premises licence authorises for the supply of alcohol

Name: Mr Daniel Davies

Address:



Telephone number:

Email:

Personal licence number and issuing authority of personal licence held by designated premises supervisor where the premises licence authorises for the supply of alcohol

Personal Licence Number: OONU-IND-02903

Issuing Authority: Carmarthenshire County Council

Dated: 17 August 2020

**Signed: pp. K. Sutt
Head of Homes and Safer Communities.**

Mandatory conditions**Mandatory conditions where licence authorises supply of alcohol.**

- a. No supply of alcohol may be made under the premises licence—**
 - i. at a time when there is no designated premises supervisor in respect of the premises licence, or**
 - ii. at a time when the designated premises supervisor does not hold a personal licence or his personal licence is suspended.**
- b. Every supply of alcohol under the premises licence must be made or authorised by a person who holds a personal licence.**

Mandatory condition where the premises licence includes a Condition that at specified times one or more individuals must be at the premises to carry out a security activity.

- a. Each such individual must be licensed by the Security Industry Authority.**
- b. But nothing in (1) above requires such a condition to be imposed—**
 - i. In respect of premises within paragraph 8(3)(a) of Schedule 2 to the Private Security Industry Act 2001 (c. 12) (premises with premises licences authorising plays or films), or**
 - ii. In respect of premises in relation to—**
 - any occasion mentioned in paragraph 8(3)(b) or (c) of that Schedule (premises being used exclusively by club with club premises certificate, under a temporary event notice authorising plays or films or under a gaming licence), or**
 - any occasion within paragraph 8(3)(d) of that Schedule (occasions prescribed by regulations under that Act).**
- c. For the purposes of this section—**
 - i. "security activity" means an activity to which paragraph 2(1)(a) of that Schedule applies, and**
 - ii. paragraph 8(5) of that Schedule (interpretation of references to an occasion) applies as it applies in relation to paragraph 8 of that Schedule.**

Mandatory condition where licence authorises the exhibition of films

- a. Where a premises licence authorises the exhibition of films, it is a condition that the admission of children to the exhibition of any film is to be restricted in accordance with any recommendation made by the British Board of Film Classification.
- b. Where the relevant licensing authority has notified the holder of the licence that this subsection applies to the film in question, admission of children must be restricted in accordance with any recommendation made by that licensing authority.
- c. In this section—
 - I. “children” means persons aged under 18; and
 - II. “film classification body” means the person or persons designated as the authority under section 4 of the Video Recordings Act 1984 (c. 39) (authority to determine suitability of video works for classification).

Mandatory Licensing Conditions

Sections 19A and 73A of the Licensing Act 2003

1. —

- (1) The responsible person must ensure that staff on relevant premises do not carry out, arrange or participate in any irresponsible promotions in relation to the premises.
- (2) In this paragraph, an irresponsible promotion means any one or more of the following activities, or substantially similar activities, carried on for the purpose of encouraging the sale or supply of alcohol for consumption on the premises –
 - (a) games or other activities which require or encourage, or are designed to require or encourage, individuals to –
 - (i) drink a quantity of alcohol within a time limit (other than to drink alcohol sold or supplied on the premises before the cessation of the period in which the responsible person is authorised to sell or supply alcohol), or
 - (ii) drink as much alcohol as possible (whether within a time limit or otherwise);
 - (b) provision of unlimited or unspecified quantities of alcohol free or for a fixed or discounted fee to the public or to a group defined by a particular characteristic in a manner which carries a significant risk of undermining a licensing objective;

- (c) provision of free or discounted alcohol or any other thing as a prize to encourage or reward the purchase and consumption of alcohol over a period of 24 hours or less in a manner which carries a significant risk of undermining a licensing objective;
 - (d) selling or supplying alcohol in association with promotional posters or flyers on, or in the vicinity of, the premises which can reasonably be considered to condone, encourage or glamorise anti-social behaviour or to refer to the effects of drunkenness in any favourable manner.
 - (e) Dispensing alcohol directly by one person into the mouth of another (other than where that other person is unable to drink without assistance by reason of a disability).
2. The responsible person must ensure that free potable water is provided on request to customers where it is reasonably available.
3. —
- (1) The premises licence holder or club premises certificate holder must ensure that an age verification policy is adopted in respect of the premises in relation to the sale or supply of alcohol.
 - (2) The designated premises supervisor in relation to the premises must ensure that the supply of alcohol at the premises is carried out in accordance with the age verification policy.
 - (3) The policy must require individuals who appear to the responsible person to be under 18 years of age (or such older age as may be specified in the policy) to produce on request, before being served alcohol, identification bearing their photograph, date of birth and either -
 - a) a holographic mark, or
 - b) an ultraviolet feature.
4. The responsible person must ensure that —
- (a) where any of the following alcoholic drinks is sold or supplied for consumption on the premises (other than alcoholic drinks sold or supplied having been made up in advance ready for sale or supply in a securely closed container) it is available to customers in the following measures —
 - (i) beer or cider: ½ pint;
 - (ii) gin, rum, vodka or whisky: 25 ml or 35 ml; and
 - (iii) still wine in a glass: 125 ml; and
 - (b) these measures are displayed in a menu, price list or other printed material which is available to customers on the premises; and
 - (c) where a customer does not in relation to a sale of alcohol specify the quantity of alcohol to be sold, the customer is made aware that these measures are available.

Licensing Act 2003 (Mandatory Conditions) Order 2014

5. (1) A relevant person shall ensure that no alcohol is sold or supplied for consumption on or off the premises for a price which is less than the permitted price.

- (2) For the purposes of the condition set out in paragraph (1) -**
(a) "duty" is to be construed in accordance with the Alcoholic Liquor Duties Act 1979;
(b) "permitted price" is the price found by applying the formula—

$$P = D + (D \times V)$$

where—

- (i) P is the permitted price,**
(ii) D is the amount of duty chargeable in relation to the alcohol as if the duty were charged on the date of the sale or supply of the alcohol, and
(iii) V is the rate of value added tax chargeable in relation to the alcohol as if the value added tax were charged on the date of the sale or supply of the alcohol;

(c) "relevant person" means, in relation to premises in respect of which there is in force a premises licence—

- (i) the holder of the premises licence,**
(ii) the designated premises supervisor (if any) in respect of such a licence,
or
(iii) the personal licence holder who makes or authorises a supply of alcohol under such a licence;

(d) "relevant person" means, in relation to premises in respect of which there is in force a club premises certificate, any member or officer of the club present on the premises in a capacity which enables the member or officer to prevent the supply in question; and

(e) "value added tax" means value added tax charged in accordance with the Value Added Tax Act 1994.

(3) Where the permitted price given by Paragraph (b) of paragraph 2 would (apart from this paragraph) not be a whole number of pence, the price given by that sub-paragraph shall be taken to be the price actually given by that sub-paragraph rounded up to the nearest penny.

(4)— (1) Sub-paragraph (2) applies where the permitted price given by Paragraph (b) of paragraph 2 on a day ("the first day") would be different from the permitted price on the next day ("the second day") as a result of a change to the rate of duty or value added tax.

(2) The permitted price which would apply on the first day applies to sales or supplies of alcohol which take place before the expiry of the period of 14 days beginning on the second day.

Annex 2

Conditions Consistent with the Operating Schedule

a) General – all four licensing objectives (b, c, d, e)

1. All staff will be given training in relation to the sale of alcohol, including acceptable forms of ID and the Challenge 21 age verification policy prior to being permitted to sell alcohol at the premises.

b) The prevention of crime and disorder

- 1. A CCTV system to be installed at the premises, to be fitted in accordance with the Operational Requirement Guidance document issued by the Carmarthenshire Division of the Dyfed Powys Police.**
- 2. The system shall be recording whenever the premises are open for licensable activities.**
- 3. The system must incorporate a means of transferring images from the hard-drive to a format that can be played back on any Windows compatible computer.**
- 4. The system must produce images, which are watermarked as part of the original recording process.**
- 5. The system must be capable of recording and retaining 31 days of images before over-recording.**
- 6. Recording equipment must record date and time information as part of the image file. The date/time must be accurate.**
- 7. All users must be fully trained in the operation of the system and be made aware of their general legal responsibilities.**
- 8. There must be a competent person present on the premises capable of replay and export of recordings quickly onto a removable storage medium at all times when the premises are open to the public.**
- 9. Any fault to the system must be reported to the Local Authority and the Police the next working day.**
- 10. The system must be registered with the Information Commissioner.**
- 11. No open glass or glass vessels to be removed from the premises, plastic or polycarbonate glasses to be used within the outside seating area to the front of the premises.**

12. The DPS to become a member of the local Pub Watch scheme and to support the BOBB scheme, 'Behave or be Banned'.
13. Whenever Regulated Entertainment takes place at the premises the DPS to risk assess specific days such as New Year's Eve and notable events and consider the use of Door Supervisors.
14. When employed Door Supervisors must be registered with the SIA, to be on duty until the time that all members of the public have left the premises.
15. The Licence Holder shall supply an appropriate number of Door Supervisors for the maximum occupancy figure stated in the licence and the appropriate number shall be 2 in respect of the first 100 persons and one for each additional 100 persons or part of 100 persons comprised in the maximum occupancy figure.
16. Door Supervisors shall not be permitted to consume intoxicating liquor or other intoxicants during any period of duty at the Premises. A Door Supervisor shall report on duty in a sober condition.
17. The Designated Premises Supervisor or Premises Licence Holder shall nominate for each and every exit door a Door Supervisor whose duty it shall be to ensure that the exit door is opened immediately in the event of a Fire or other Emergency and if practicable no more than one door shall be designated to each Door Supervisor.
18. No Door Supervisors shall be engaged in any duty that would otherwise prevent him, carrying out his duty as a Door Supervisor or exercising general supervision and control of persons attending the Premises.
19. Door supervisors to remain on duty after Regulated Entertainment ends until permitted hours in respect of the supply of alcohol finishes.
20. The consumption of alcohol by customers at the premises must cease at or before the end of opening hours as specified in the premises licence. Staff are required to collect all alcoholic drinks prior to the end of the opening hours set out in the licence.

c) Public Safety

d) The prevention of public nuisance

1. Neighbour courtesy notices to be displayed at the premises.

e) The protection of children from harm

1. The 'Challenge 21' scheme to be adopted at the premises with notices and posters to be clearly displayed in the premises, near the entrances and bar areas. To emphasise to customers that they will be challenged if they look 21 and under.

- 2. No person under the age of 18 shall be employed on the premises whether paid or unpaid for the purpose of serving alcohol.**
- 3. No children under the age of 16 years to remain on the premises after 21:00 unless they are attending a pre-booked function or event and in the company of a parent or responsible adult.**
- 4. No children's discos to take place on the premises unless parents/guardians or responsible adults are present at all times.**

Annex 3



Conditions attached after a hearing by the Licensing Authority.

N/A

Annex 4 – Containing plans of the licensed premises is attached.

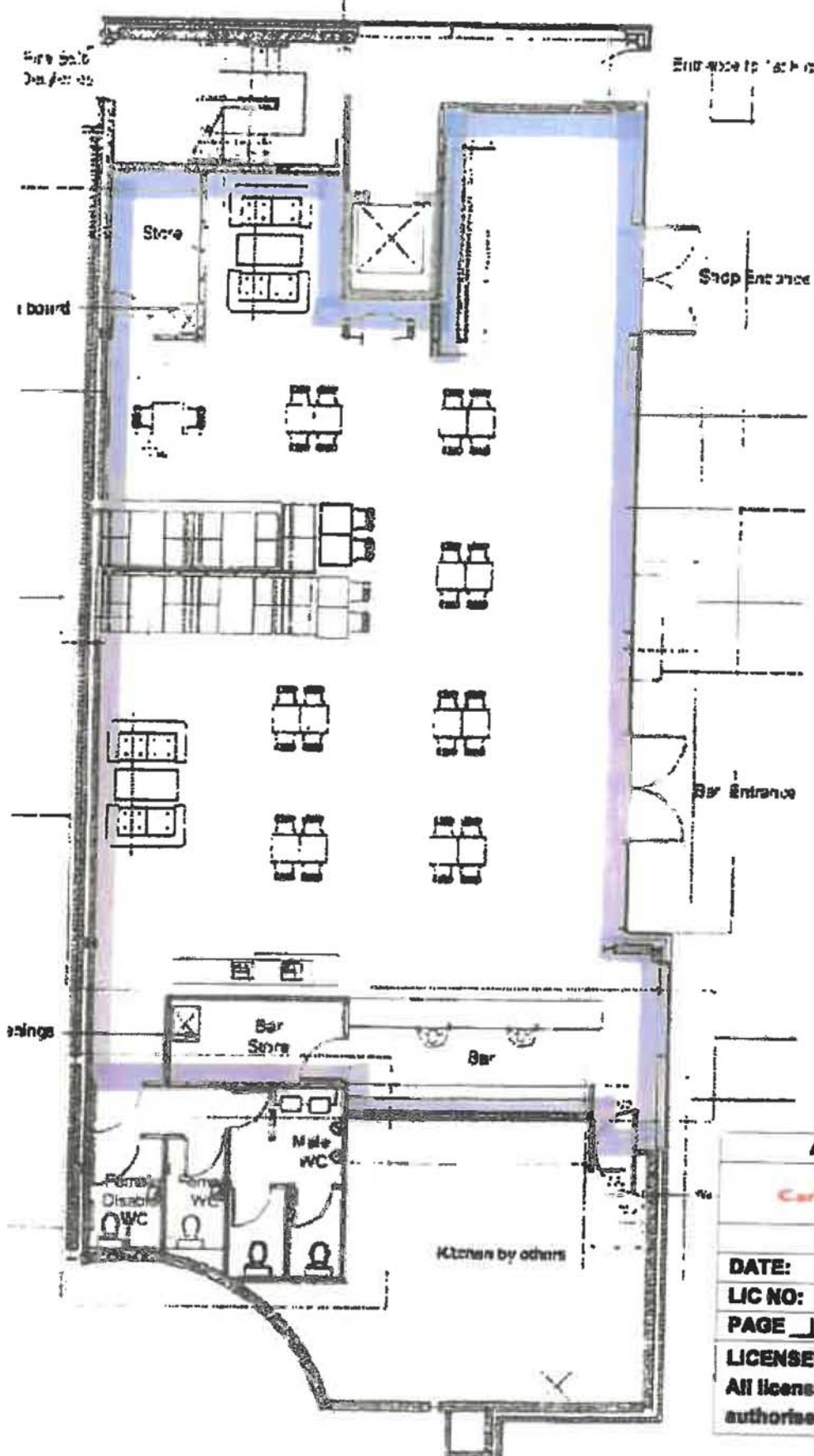
Possible Layout



ANNEX 4 - PLANS

NOT TO SCALE
DATE: <u>15 / 12 / 2014</u>
LIC NO: OONU - PRM - 01119
PAGE <u>1</u> OF <u>1</u>
LICENSED AREA(S): All licensable activities authorised by this Licence. 

GI

From: Carrie Gillam
Sent: 24 November 2021 09:58
To: Andrew Rees <RARees@carmarthenshire.gov.uk>; DANIEL DAVIES
Subject: Clockwork Tavern

Hi Andrew,

We'd like to amend the application and change the times back to the following...

Live Music/DJ/live shows to its original 1am finish.

The Sale of Alcohol from 2.30am back to 2am.

Venue Closure from 3am back to 2.30am.

Supporting this application, we have already put the following steps in place..

- Moved entry/exit of the premises to the rear doors being further away from the residents homes.
- Moved all Live Acts/entertainment into the VIP closure away from entry/exit doors which dampens the noise levels leaving the premises.
- All Live music is now acoustic acts only!! No drums, electric guitar's etc allowed.
- All Live Acts play through venues music system therefore sound levels are controlled.
- Only 15 persons are allowed outside the premises at any one time for a cigarette.
- 2 SIA Door Staff are on the entrance at all times controlling traffic entering and leaving the premises.
- Pending approval, a decibel meter is welcomed to be put in place to control noise levels, this can be set at a certain volume and if detected above acceptable levels for more than 5 seconds, all music will be automatically shut off at the system immediately.
- Wind Breakers set up outside the main entrance, directing customers when leaving the premises away from the direction of the residents homes.

If there's anything else you need from us, please let us know

Kind regards
Carrie Gillam



Kind Regards,
Carrie Gillam
Venue General Manager / Lleoliad Rheolwr Cyffredinol
01554 783902

Scarlets Regional Ltd., Parc y Scarlets
Parc Pemberton, Llanelli, Sir Gâr, SA14 9UZ