



Carmarthenshire
Application to vary a premises licence
Licensing Act 2003

For help contact
 SCHLicensing@carmarthenshire.gov.uk
 Telephone: 01267 228 924

* required information

Section 1 of 19

You can save the form at any time and resume it later. You do not need to be logged in when you resume.

System reference

Not Currently In Use

This is the unique reference for this application generated by the system.

Your reference

Notts bar ltd

You can put what you want here to help you track applications if you make lots of them. It is passed to the authority.

Are you an agent acting on behalf of the applicant?

Yes

No

Put "no" if you are applying on your own behalf or on behalf of a business you own or work for.

Applicant Details

* First name

Steven

* Family name

Davies

* E-mail

Main telephone number

Include country code.

Other telephone number

Indicate here if you would prefer not to be contacted by telephone

Are you:

Applying as a business or organisation, including as a sole trader

Applying as an individual

A sole trader is a business owned by one person without any special legal structure. Applying as an individual means you are applying so you can be employed, or for some other personal reason, such as following a hobby.

Applicant Business

Is your business registered in the UK with Companies House?

Yes

No

Note: completing the Applicant Business section is optional in this form.

Registration number

10470957

Business name

NOTTS BAR LTD

If your business is registered, use its registered name.

VAT number

- NONE

Put "none" if you are not registered for VAT.

Legal status

Private Limited Company

Continued from previous page...

Your position in the business	Director	
Home country	United Kingdom	The country where the headquarters of your business is located.
Registered Address		Address registered with Companies House.
Building number or name	Gwynne house	
Street	6 quay street	
District		
City or town	Carmarthen	
County or administrative area		
Postcode	SA31 3JX	
Country	United Kingdom	

Section 2 of 17

APPLICATION DETAILS

This application cannot be used to vary the licence so as to extend the period for which the licence has effect or to vary substantially the premises to which it relates. If you wish to make that type of change to the premises licence, you should make a new premises licence application under section 17 of the Licensing Act 2003.

I/we, as named in section 1, being the premises licence holder, apply to vary a premises licence under section 34 of the Licensing Act 2003 for the premises described in section 2 below.

* Premises Licence Number

Are you able to provide a postal address, OS map reference or description of the premises?

Address OS map reference Description

Postal Address Of Premises

Building number or name	16
Street	NOTT SQUARE
District	
City or town	Carmarthen
County or administrative area	Carmarthenshire
Postcode	SA31 1PQ
Country	United Kingdom

Premises Contact Details

Telephone number

Continued from previous page...

Non-domestic rateable value of premises (£)

6,682.5

Section 3 of 17

VARIATION

Do you want the proposed variation to have effect as soon as possible?

Yes

No

Do you want the proposed variation to have effect in relation to the introduction of the late night levy?

Yes

No

You do not have to pay a fee if the only purpose of the variation for which you are applying is to avoid becoming liable to the late night levy.

If your proposed variation could mean that 5,000 or more people are expected to attend the premises at any one time, state the number expected to attend

[Empty box for number of attendees]

Describe Briefly The Nature Of The Proposed Variation

Describe the premises. For example the type of premises, its general situation and layout and any other information which could be relevant to the licensing objectives. Where your application includes off-supplies of alcohol and you intend to provide a place for consumption of these off-supplies, you must include a description of where the place will be and its proximity to the premises.

Extend the hours of recorded music and the sale of alcohol on Friday and Saturday nights.

Section 4 of 17

DIVISION OF PLAYS

Will the schedule to provide plays be subject to change if this application to vary is successful?

Yes

No

Section 5 of 17

PROVISION OF FILMS

Will the schedule to provide films be subject to change if this application to vary is successful?

Yes

No

Section 6 of 17

PROVISION OF INDOOR SPORTING EVENTS

Will the schedule to provide indoor sporting events be subject to change if this application to vary is successful?

Continued from previous page...

Yes

No

PROVISION OF BOXING OR WRESTLING ENTERTAINMENTS

Will the schedule to provide boxing or wrestling entertainments be subject to change if this application to vary is successful?

Yes

No

PROVISION OF LIVE MUSIC

Will the schedule to provide live music be subject to change if this application to vary is successful?

Yes

No

PROVISION OF RECORDED MUSIC

Will the schedule to provide recorded music be subject to change if this application to vary is successful?

Yes

No

Standard Days And Timings

MONDAY

Start

End

Start

End

TUESDAY

Start

End

Start

End

WEDNESDAY

Start

End

Start

End

THURSDAY

Start

End

Start

End

FRIDAY

Start

End

Start

End

SATURDAY

Start

End

Start

End

Provide timings in 24 hour clock (e.g., 16:00) and only give details for the days of the week when you intend the premises to be used for the activity.

Continued from previous page...

SUNDAY

Start 18:00

End 23:00

Start

End

Will the playing of recorded music take place indoors or outdoors or both?

- Indoors Outdoors Both

Where taking place in a building or other structure select as appropriate. Indoors may include a tent.

State type of activity to be authorised, if not already stated, and give relevant further details, for example (but not exclusively) whether or not music will be amplified or unamplified.

Music will be amplified for indoor use only.

State any seasonal variations for playing recorded music.

example (but not exclusively) where the activity will occur on additional days during the summer months.

Indoor use only.

Non-standard timings. Where the premises will be used for the playing of recorded music at different times from those listed above, list below.

For example (but not exclusively), where you wish the activity to go on longer on a particular day e.g. Christmas Eve.

Bank holidays, boxing night and new years eve.

Section 10 of 17

PROVISION OF PERFORMANCES OF DANCE

Will the schedule to provide performances of dance be subject to change if this application to vary is successful?

- Yes No

Section 11 of 17

PROVISION OF ANYTHING OF A SIMILAR DESCRIPTION TO LIVE MUSIC, RECORDED MUSIC OR PERFORMANCES OF DANCE

Will the schedule to provide anything similar to live music, recorded music or performances of dance be subject to change if this application to vary is successful?

- Yes No

Section 12 of 17

PROVISION OF LATE NIGHT REFRESHMENT

Continued from previous page...

Will the schedule to provide late night refreshment be subject to change if this application to vary is successful?

Yes No

SUPPLY OF ALCOHOL

Will the schedule to supply alcohol be subject to change if this application to vary is successful?

Yes No

Standard Days And Timings

MONDAY

Start

End

Start

End

TUESDAY

Start

End

Start

End

WEDNESDAY

Start

End

Start

End

THURSDAY

Start

End

Start

End

FRIDAY

Start

End

Start

End

SATURDAY

Start

End

Start

End

SUNDAY

Start

End

Start

End

Provide timings in 24 hour clock (e.g., 16:00) and only give details for the days of the week when you intend the premises to be used for the activity.

Continued from previous page...

Will the sale of alcohol be for consumption?

- On the premises
 Off the premises
 Both

If the sale of alcohol is for consumption on the premises select on, if the sale of alcohol is for consumption away from the premises select off. If the sale of alcohol is for consumption on the premises and away from the premises select both.

State any seasonal variations.

For example (but not exclusively) where the activity will occur on additional days during the summer months.

Non-standard timings. Where the premises will be used for the supply of alcohol at different times from those listed above, below.

For example (but not exclusively), where you wish the activity to go on longer on a particular day e.g. Christmas Eve.

Section 14 of 17

ADULT ENTERTAINMENT

Highlight any adult entertainment or services, activities, or other entertainment or matters ancillary to the use of the premises that may give rise to concern in respect of children.

Provide information about anything intended to occur at the premises or ancillary to the use of the premises which may give rise to concern in respect of children, regardless of whether you intend children to have access to the premises, for example (but not exclusively) nudity or semi-nudity, films for restricted age groups etc gambling machines etc.

Section 15 of 17

HOURS PREMISES ARE OPEN TO THE PUBLIC

Standard Days And Timings

MONDAY

Start

End

Start

End

TUESDAY

Start

End

Start

End

Provide timings in 24 hour clock (e.g., 16:00) and only give details for the days of the week when you intend the premises to be used for the activity.

Continued from previous page...

WEDNESDAY

Start	<input type="text" value="11:00"/>	End	<input type="text" value="23:00"/>
Start	<input type="text"/>	End	<input type="text"/>

THURSDAY

Start	<input type="text" value="11:00"/>	End	<input type="text" value="01:00"/>
Start	<input type="text"/>	End	<input type="text"/>

FRIDAY

Start	<input type="text" value="11:00"/>	End	<input type="text" value="02:00"/>
Start	<input type="text"/>	End	<input type="text"/>

SATURDAY

Start	<input type="text" value="11:00"/>	End	<input type="text" value="02:00"/>
Start	<input type="text"/>	End	<input type="text"/>

SUNDAY

Start	<input type="text" value="11:00"/>	End	<input type="text" value="23:00"/>
Start	<input type="text"/>	End	<input type="text"/>

State any seasonal variations.

For example (but not exclusively) where the activity will occur on additional days during the summer months.

Non standard timings. Where you intend to use the premises to be open to the members and guests at different times from those listed above, list below.

For example (but not exclusively), where you wish the activity to go on longer on a particular day e.g. Christmas Eve.

bank holidays , boxing night and new years eve

Identify those conditions currently imposed on the licence which you believe could be removed as a consequence of the proposed variation you are seeking.

I have enclosed the premises licence

Continued from previous page...

I have enclosed the relevant part of the premises licence

Reasons why I have failed to enclose the premises licence or relevant part of premises licence.

Section 16 of 17

LICENSING OBJECTIVES

Describe the steps you intend to take to promote the four licensing objectives:

a) General – all four licensing objectives (b,c,d,e)

List here steps you will take to promote all four licensing objectives together.

To promote all four licensing objectives via strong management control and effective training for all staff, to ensure awareness of the premises licence to ensure all requirements are met for the four objectives.

b) The prevention of crime and disorder

CCTV installed to monitor all parts of premises, entrances and outdoor area, to address the prevention of crime objectives. Door staff to work on main nights, eg, Friday, Saturdays and bank holidays.

c) Public safety

All staff trained in ID checks, with challenge 21 promoted in the venue, door staff checking ID at the main entrance.

d) The prevention of public nuisance

Noise reduction measures to address public nuisance, door staff to work on expected busy nights / weekends.

e) The protection of children from harm

Challenge 21 to operate in the venue, with no under 18s in the premises after 22:00 and only before 22:00 if and only when with a responsible adult and only when for a meal is purchased.

Section 17 of 17

PAYMENT DETAILS

This fee must be paid to the authority. If you complete the application online, you must pay it by debit or credit card.

For detailed guidance on the fee structure, please refer to the table on Page 4, 5 and 6 of the guidance document.

* Fee amount (£)

190.00

Continued from previous page...

DECLARATION

- * I understand it is an offence, liable on summary conviction to a fine not exceeding level 5 on the standard scale, under section 158 of the Licensing Act 2003, to make a false statement in or in connection with this application.
 - * I understand that I must now advertise my application.
 - * I understand that if I do not comply with the requirements my application will be rejected.
- Ticking this box indicates you have read and understood the above declaration

This section should be completed by the applicant, unless you answered "Yes" to the question "Are you an agent acting on behalf of the applicant?"

* Full name

* Capacity

* Date / /
dd mm yyyy

Once you're finished you need to do the following:

1. Save this form to your computer by clicking file/save as...
2. Go back to <https://www.gov.uk/apply-for-a-licence/premises-licence/carmarthenshire/change-1> to upload this file and continue with your application.

Don't forget to make sure you have all your supporting documentation to hand.

IT IS AN OFFENCE, LIABLE ON SUMMARY CONVICTION TO A FINE NOT EXCEEDING LEVEL 5 ON THE STANDARD SCALE, UNDER SECTION 158 OF THE LICENSING ACT 2003, TO MAKE A FALSE STATEMENT IN OR IN CONNECTION WITH THIS APPLICATION

OFFICE USE ONLY

Applicant reference number	<input type="text" value="Notts bar ltd"/>
Fee paid	<input type="text"/>
Payment provider reference	<input type="text"/>
ELMS Payment Reference	<input type="text"/>
Payment status	<input type="text"/>
Payment authorisation code	<input type="text"/>
Payment authorisation date	<input type="text"/>
Date and time submitted	<input type="text"/>
Approval deadline	<input type="text"/>
Error message	<input type="text"/>
Is Digitally signed	<input type="checkbox"/>

Eich cyf / Your ref:

Fy nghyf / My ref:

Dyddiad / Date: 28th March 2017

Gofynner am / Please ask for:

Llinell Unlongyrchol / Direct Line:

E-bost / E-mail:

Emyr Jones

(01267) 228717

publicprotection@carmarthenshire.gov.uk

B1

Head of Housing and Public Protection
Carmarthenshire County Council
3 Spilman Street,
Carmarthen
SA31 1LE

Dear Sir,

**RE: Application to vary a Premises Licence
Notts Bar, 16 Nott Square, Carmarthen, Carmarthenshire, SA31 1PQ
Application Date 28/02/2017**

Further to the receipt of the above application, the Licensing Authority make the following representations:

a) Previous Enforcement Action / Prosecutions

There have been no previous prosecutions taken by the licensing authority in relation to these premises. However officers have met with the Licence holder in May 2016 to discuss the management of the outside areas at the premises after witnessing a patron throwing a glass bottle and another customer urinating in an adjacent shop doorway. The licence holder was also warned after officers witnessed customers on the same occasion consuming alcohol in the outside area of the premises after 22.00, in breach of the licence conditions.

b) Complaints.

The licensing authority has received a complaint from an adjacent shop premises alleging that customers of the Notts Bar were responsible for problems of vomit and cigarette butts littering the shop doorway. The licence holder was made aware of the allegation in January 2016.

c) Responsible Authority Referrals.

The licensing authority has not received any referrals from the other responsible authorities in relation to the above premises.

d) Relevant Sections of the Statutory Guidance.

The Licensing Authority believes that the following sections of the Statutory Guidance are relevant to this licence application: - Section 1 Introduction,

Robin Staines BA (Hons.), MA, MCIH

Pennaeth Tai & Diogelu'r Cyhoedd

Adran Cymunedau

3 Heol Spilman, Caerfyrddin, SA31 1LE.

Tŷ Elwyn, Llanelli, SA15 3AP.

Neuadd y Dref, Heol Iscennen, Rhydaman, SA18 3BE.

Head of Housing & Public Protection

Department for Communities

3 Spilman Street, Carmarthen, SA31 1LE.

Tŷ Elwyn, Llanelli, SA15 3AP.

Town Hall, Iscennen Road, Ammanford, SA18 3BE.



BUDDSODDWMYR | INVESTORS
MEWN POBL | IN PEOPLE

B2

Section 2 relating to The Licensing Objectives, Section 5 relating to Premises Licences, Section 8 relating to Applications for Premises Licences and Section 10 relating to Licence Conditions.

e) Relevant Sections of the Local Licensing Policy.

The Licensing Authority believes that the following sections of Carmarthenshire's Licensing Policy are relevant to this licence application:- Section 3 Fundamental principles, Section 4 Conditions of Licence, Sections 5 – 9 relating to The Licensing Objectives and Section 11 relating to Licensing Hours. In particular, the revision to the Licensing Policy adopted in February 2016 at section 6.12 identifies Nott Square as a hot spot of alcohol related crime and disorder.

f) Proposed Operating Schedule.

Having considered the current application and the operating schedule put forward by the applicant, the Licensing Authority believes that, if the application were granted, the wording set out in the operating schedule, is not sufficiently precise to enable it to form clear enforceable licence conditions in accordance with section 18(2)(a) of the Licensing Act .

The Dyfed Powys Police have submitted letters of representation in relation to the application. The Police representation requests that an additional condition be attached to the licence should the application be granted. The Police representation also requests a reduction in the requested permitted hours for the sale of alcohol to allow for a drinking up period prior to the premises closing.

Given the location of the premises in an alcohol hot spot area and the challenges of operating existing licence conditions which require the consumption of alcohol to cease at 22.00 in the pavement café area and for glass vessels not to be removed from the licensed area of the premises, I believe it would be appropriate to replace all the statements made in the operating schedule with the condition requested by the Police in their representations dated 15/03/17.

These representations have been prepared on the 28th of March 2017 with the benefit of viewing the original application and representations from the Police.

I would be grateful if the applicant could contact me to discuss the above representations at the earliest opportunity and certainly prior to the application being referred to a Licensing Sub Committee hearing for determination.

If you require any further information or assistance, please do not hesitate to contact me.

Yours faithfully,

Mr E O R Jones
Principal Licensing Officer

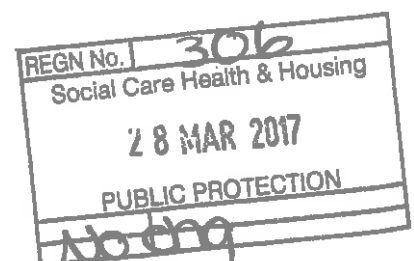



Heddlu Police
DYFED-POWYS

Prif Gwnetabl / Chief Constable

CI

Pencadlys Heddlu Dyfed-Powys, Blwch Post 99, Llangynnwr, Caerfyrddin, SA31 2PF.
Dyfed-Powys Police Headquarters, PO Box 99, Llangynnor, Carmarthen, SA31 2PF.

- Ffôn/Tel : 101
01267 222020 y tu allan I ardal Dyfed-Powys
01267 222020 if outside the Dyfed-Powys area
- Ffacs/Fax : 01267 222165
- DX : Dyfed-Powys Police DX 120325 Carmarthen 4

Eich cyf. / Your ref.

Efn cyf. / Our ref.

Gofynnwch am: / Please ask for:

PRG549vary./MP

Mike Price
Divisional Licensing Officer
01269 590578

email mike.price@dyfed-powys.pnn.police.uk

Mr EOR Jones
Principal Licensing Officer
Carmarthenshire County Council
3 Spilman Street
Carmarthen
SA31 1LE

Mr. Steven Davies
7 Parc-Yr-Onen
Carmarthen
Carmarthenshire
SA31 1ED

Wednesday 15th.March 2017

Dear Sir,

**Re: Variation of Premises Licence – Notts Bar, 16 Nott Square, Carmarthen,
Carmarthenshire SA31 1PQ**

Applicant – Mr. Steven Davies.

Date completed application received – 28/02/17

With reference to the above application for the Variation of a Premises Licence the following Licensing Activities are applied for.

Recorded Music

Friday and Saturday 18.00 to 02.00

Supply of Alcohol - on premises only.

Friday and Saturday 11.00 to 02.00

Prif Gwnetabl **Mark Collins** - Chief Constable

Mae Heddlu Dyfed-Powys yn croeseawu gohebiaeth yn Gymraeg a Saesneg. Byddwn ni'n eiohau ein bod ni'n ymateb yn eioh dewie laith ac ni fydd oedl mewn perthynas ag unrhyw ohebiaeth drwy'r Gymraeg.

Dyfed-Powys Police welcomes correspondence in Welsh and in English, and we will ensure that we respond to any correspondence through the language of your choice. Corresponding via the medium of Welsh will not endure any delay.



www.dyfed-powys.police.uk



C2

With the premises open to the public.

Friday and Saturday 11.00 to 02.00

No Seasonal Variations.

Non Standard Timings

Bank Holiday and Boxing Night, no additional hours applied for.

The hours applied for until 02.00hrs for Licensing Activities are the same as those for the premises to close. No allowance has been made for a period of 'drinking up time'.

The Police have concerns that alcohol can be supplied up until 02.00hrs which is the same time as the premises must close; this in turn could lead to issues of Crime and Disorder taking place on the premises.

Therefore the Police would ask the applicant to amend his application so that all Licensable Activities end at 01.30hrs on the days applied for, this will allow a period of time for members of the public to finish their drinks and leave the premises prior to 02.00hrs.

With reference to the above application the Carmarthenshire Division of the Dyfed Powys Police will make the following representations.

1. Whenever the premises are open beyond 01.00hrs door Supervisors to be on duty until 02.00hrs or until all members of the public have left.

The above conditions the police believe are necessary and appropriate to promote the Licensing Objectives.

I would grateful if you could contact me to discuss the above representations at your earliest.

I submit the above for your consideration and comment.

Yours Sincerely

Mike Price

Divisional Licensing Officer

PREMISES LICENCE LICENSING ACT 2003

Premises licence number

No: OONU-PRM-01228

Part 1 - Premises details

Postal address of premises, or if none, ordnance survey map reference or description
Address Notts Bar 16 Nott Square Carmarthen Carmarthenshire SA31 1PQ
Telephone number

Where the licence is time limited the dates This Premises Licence is not time limited.

Licensable activities authorised by the licence <ul style="list-style-type: none">• Sale by retail of alcohol.• Regulated Entertainment (As specified overleaf). <p>The above activities may only be conducted within the areas of the premises licensed for those specific activities, as shown on the plan attached to this licence as Annex 4.</p>

D2

**The Times The Licence Authorises The Carrying Out Of
Licensable Activities**

Supply of alcohol

Standard days and timings

**Sunday to Wednesday 11:00-23:00
Thursday to Saturday 11:00-01:00**

Non Standard timings.

New Years Eve, Bank Holidays and Bank Holiday Sunday 11:00-02:00

Live Music

Standard days and timings

**Sunday to Wednesday 18:00-23:00
Thursday to Sunday 18:00-01:00**

Indoors in the areas licensed at the premises for this activity.

Non Standard timings.

New Years Eve, Bank Holidays and Bank Holiday Sunday 11:00-02:00

Recorded Music

Standard days and timings

**Sunday to Wednesday 18:00-23:00
Thursday to Sunday 18:00-01:00**

Indoors in the areas licensed at the premises for this activity.

Non Standard timings.

New Years Eve, Bank Holidays and Bank Holiday Sunday 11:00-02:00

The opening hours of the premises

Standard days and timings

**Sunday to Wednesday 11:00-23:00
Thursday to Saturday 11:00-01:00**

Non Standard timings.

New Years Eve, Bank Holidays and Bank Holiday Sunday 11:00-02:00

In relation to the morning on which summertime begins, where the terminal hour specified in the licence is 1am or later, it shall be extended by one hour.

Where the licence authorises supplies of alcohol whether these are on and/or off supplies

This premises licence authorises the supply of alcohol for consumption on the premises.

Part 2

D3

Name, (registered) address, telephone number and email (where relevant) of holder of premises licence

Name: Mr Steven Davies

**Address: 7 Parc-Yr-Onen
Carmarthen
Carmarthenshire
SA31 1ED**

**Telephone number: 01267 230626
Email:**

Registered number of holder, for example company number, charity number (where applicable)

Name, address and telephone number of designated premises supervisor where the premises licence authorises for the supply of alcohol

Name: Mr Steven Davies

**Address: 7 Parc-Yr-Onen
Carmarthen
Carmarthenshire
SA31 1ED**

**Telephone number: 01267 230626
Email:**

Personal licence number and issuing authority of personal licence held by designated premises supervisor where the premises licence authorises for the supply of alcohol

Personal Licence Number: OONU-IND-01348

Issuing Authority: Carmarthenshire

Dated: 28 April 2016

Signed:



Head of Housing & Public Protection.

Mandatory conditions

Mandatory conditions where licence authorises supply of alcohol.

- a. No supply of alcohol may be made under the premises licence—
 - i. at a time when there is no designated premises supervisor in respect of the premises licence, or
 - ii. at a time when the designated premises supervisor does not hold a personal licence or his personal licence is suspended.
- b. Every supply of alcohol under the premises licence must be made or authorised by a person who holds a personal licence.

Mandatory condition where the premises licence includes a Condition that at specified times one or more individuals must be at the premises to carry out a security activity:

- a. Each such individual must be licensed by the Security Industry Authority.
- b. But nothing in (1) above requires such a condition to be imposed—
 - i. In respect of premises within paragraph 8(3)(a) of Schedule 2 to the Private Security Industry Act 2001 (c. 12) (premises with premises licences authorising plays or films), or
 - ii. in respect of premises in relation to—
 - any occasion mentioned in paragraph 8(3)(b) or (c) of that Schedule (premises being used exclusively by club with club premises certificate, under a temporary event notice authorising plays or films or under a gaming licence), or
 - any occasion within paragraph 8(3)(d) of that Schedule (occasions prescribed by regulations under that Act).
- c. For the purposes of this section—
 - i. “security activity” means an activity to which paragraph 2(1)(a) of that Schedule applies, and
 - ii. paragraph 8(5) of that Schedule (interpretation of references to an occasion) applies as it applies in relation to paragraph 8 of that Schedule.

Mandatory Licensing Conditions
Sections 19A and 73A of the Licensing Act 2003

1. —

- (1) The responsible person must ensure that staff on relevant premises do not carry out, arrange or participate in any irresponsible promotions in relation to the premises.
- (2) In this paragraph, an irresponsible promotion means any one or more of the following activities, or substantially similar activities, carried on for the purpose of encouraging the sale or supply of alcohol for consumption on the premises —

(a) games or other activities which require or encourage, or are designed to require or encourage, individuals to —

- (i) drink a quantity of alcohol within a time limit (other than to drink alcohol sold or supplied on the premises before the cessation of the period in which the responsible person is authorised to sell or supply alcohol), or
- (ii) drink as much alcohol as possible (whether within a time limit or otherwise);

(b) provision of unlimited or unspecified quantities of alcohol free or for a fixed or discounted fee to the public or to a group defined by a particular characteristic in a manner which carries a significant risk of undermining a licensing objective;

(c) provision of free or discounted alcohol or any other thing as a prize to encourage or reward the purchase and consumption of alcohol over a period of 24 hours or less in a manner which carries a significant risk of undermining a licensing objective;

(d) selling or supplying alcohol in association with promotional posters or flyers on, or in the vicinity of, the premises which can reasonably be considered to condone, encourage or glamorise anti-social behaviour or to refer to the effects of drunkenness in any favourable manner.

(e) Dispensing alcohol directly by one person into the mouth of another (other than where that other person is unable to drink without assistance by reason of a disability).

2. The responsible person must ensure that free potable water is provided on request to customers where it is reasonably available.

3. —

- (1) The premises licence holder or club premises certificate holder must ensure that an age verification policy is adopted in respect of the premises in relation to the sale or supply of alcohol.

- (2) The designated premises supervisor in relation to the premises must ensure that the supply of alcohol at the premises is carried out in accordance with the age verification policy.
- (3) The policy must require individuals who appear to the responsible person to be under 18 years of age (or such older age as may be specified in the policy) to produce on request, before being served alcohol, identification bearing their photograph, date of birth and either -
- a) a holographic mark, or
 - b) an ultraviolet feature.
4. The responsible person must ensure that -
- (a) where any of the following alcoholic drinks is sold or supplied for consumption on the premises (other than alcoholic drinks sold or supplied having been made up in advance ready for sale or supply in a securely closed container) it is available to customers in the following measures -
 - (i) beer or cider: ½ pint;
 - (ii) gin, rum, vodka or whisky: 25 ml or 35 ml; and
 - (iii) still wine in a glass: 125 ml; and
 - (b) these measures are displayed in a menu, price list or other printed material which is available to customers on the premises; and
 - (c) where a customer does not in relation to a sale of alcohol specify the quantity of alcohol to be sold, the customer is made aware that these measures are available.

Licensing Act 2003 (Mandatory Conditions) Order 2014

5. (1) A relevant person shall ensure that no alcohol is sold or supplied for consumption on or off the premises for a price which is less than the permitted price.

- (2) For the purposes of the condition set out in paragraph (1) -
- (a) "duty" is to be construed in accordance with the Alcoholic Liquor Duties Act 1979;
 - (b) "permitted price" is the price found by applying the formula—

$$P = D + (D \times V)$$

where—

- (i) P is the permitted price,
- (ii) D is the amount of duty chargeable in relation to the alcohol as if the duty were charged on the date of the sale or supply of the alcohol, and
- (iii) V is the rate of value added tax chargeable in relation to the alcohol as if the value added tax were charged on the date of the sale or supply of the alcohol;

(c) "relevant person" means, in relation to premises in respect of which there is in force a premises licence—

- (i) the holder of the premises licence,**
- (ii) the designated premises supervisor (if any) in respect of such a licence, or**
- (iii) the personal licence holder who makes or authorises a supply of alcohol under such a licence;**

(d) "relevant person" means, in relation to premises in respect of which there is in force a club premises certificate, any member or officer of the club present on the premises in a capacity which enables the member or officer to prevent the supply in question; and

(e) "value added tax" means value added tax charged in accordance with the Value Added Tax Act 1994.

(3) Where the permitted price given by Paragraph (b) of paragraph 2 would (apart from this paragraph) not be a whole number of pennies, the price given by that sub-paragraph shall be taken to be the price actually given by that sub-paragraph rounded up to the nearest penny.

(4)— (1) Sub-paragraph (2) applies where the permitted price given by Paragraph (b) of paragraph 2 on a day ("the first day") would be different from the permitted price on the next day ("the second day") as a result of a change to the rate of duty or value added tax.

(2) The permitted price which would apply on the first day applies to sales or supplies of alcohol which take place before the expiry of the period of 14 days beginning on the second day.

Conditions Consistent with the Operating Schedule**a) General – all four licensing objectives (b, c, d, e)**

- 1. The consumption of alcohol by customers at the premises must cease at or before the end of opening hours as specified in the premises licence. Staff are required to collect all alcoholic drinks prior to the end of the opening hours as set out in the licence.**

b) The prevention of crime and disorder

- 1. The whole of the licensed area with entry and exit areas must be covered by cameras and there must not be any hidden or obscured areas. This will deal with issues which have arisen outside the premises when customers have been arriving or leaving.**
- 2. Main entrance exit to have a camera meeting a minimum 100% R Image quality.**
- 3. All footage must be of good quality and of a minimum performance capability sufficient to identify individuals.**
- 4. It must be in colour.**
- 5. It must record a minimum of 12 images per second.**
- 6. All images must be time and date stamped.**
- 7. All footage during the hours of licensable activities to be retained for a period of 30 days.**
- 8. The CCTV system must operate continuously, and if a defect arises the police must be informed and immediate arrangements must be made to rectify the fault.**
- 9. All footage must on demand be made available to a Police Officer, Police Community Support Officer and Local Authority Officer for viewing and a copy of that footage made immediately available to the above officers.**
- 10. At all times during the period of operation of the premises there must be a competent person on the premises capable of replay and be able to undertake the export of recordings quickly onto a removable storage medium. Memory Stick, CD, or DVD format is acceptable to the police. The master copy will be available to the police on demand.**
- 11. The system must incorporate a means of transferring images from the hard-drive format that can be played back on any Microsoft Windows or MAC compatible computer. The application software required to launch and view recorded images must either be included as part of the standard operating system installed or be installed to the recorded media when the data is copied to that media.**
- 12. The system must be registered with the Information Commissioner.**
- 13. The DPS to become a member of the local Pub Watch scheme and to support the BOBB scheme, 'Behave or be Banned'.**

14. The applicant to risk assess the use of Door Supervisors whenever Regulated Entertainment is provided after 11 p.m.
15. The applicant to also risk assess the use of door supervisors at all other times for Regulated Entertainment, if provided before 11 p.m, especially on Bank Holiday weekends, Christmas Eve, Boxing Day, and New Years Eve and major televised sporting events.
16. When employed Door Supervisors must be registered with the SIA, to be on duty until the time that all members of the public have left the premises.
17. The Licence Holder shall supply an appropriate number of Door Supervisors for the maximum occupancy figure stated in the licence and the appropriate number shall be 2 in respect of the first 100 persons and one for each additional 100 persons or part of 100 persons comprised in the maximum occupancy figure.
18. Door Supervisors shall not be permitted to consume intoxicating liquor or other intoxicants during any period of duty at the Premises. A Door Supervisor shall report on duty in a sober condition.
19. The Designated Premises Supervisor or Premises Licence Holder shall nominate for each and every exit door a Door Supervisor whose duty it shall be to ensure that the exit door is opened immediately in the event of a Fire or other Emergency and if practicable no more than one door shall be designated to each Door Supervisor.
20. No Door Supervisors shall be engaged in any duty that would otherwise prevent him, carrying out his duty as a Door Supervisor or exercising general supervision and control of persons attending the Premises.
21. Door supervisors to remain on duty after Regulated Entertainment ends until permitted hours in respect of the supply of alcohol finishes.

c) Public Safety

1. No open glass or glass vessels to be removed from the boundary of the premises.

d) The prevention of public nuisance

1. That there is a terminal hour of 22:00 for the consumption of alcohol within the street cafe area to the front of the premises.
2. All external seating and tables shall be removed or made unavailable for use no later than 23:00 each day.
3. During periods of regulated entertainment all external windows and doors shall be kept closed, other than for access and egress to the premise.
4. No speakers shall be installed in external areas.
5. A suitable receptacle must be provided at the front of the property for customers to dispose of their cigarette ends and to ensure that the receptacles are emptied appropriately on closing.

D10

6. Staff to regularly monitor the external area immediately to the front of the premises and up to 3 meters on either side of the premises in order to ensure that the area is kept clear from cigarette ends, refuse and any drinking vessels.

e) The protection of children from harm

- 1. The 'Challenge 21' scheme to be adopted at the premises with notices and posters to be clearly displayed in the premises, near the entrances and bar areas. To emphasise to customers that they will be challenged if they look 21 and under.**
- 2. No person under the age of 18 shall be employed on the premises whether paid or unpaid for the purpose of serving alcohol.**
- 3. No children under the age of 16 years to remain on the premises after 22:00 unless they are attending a pre-booked function or event and in the company of a parent or responsible adult.**

Annex 3

Conditions attached after a hearing by the Licensing Authority.

N/A

Annex 4 – Containing plans of the licensed premises is attached.

D 11

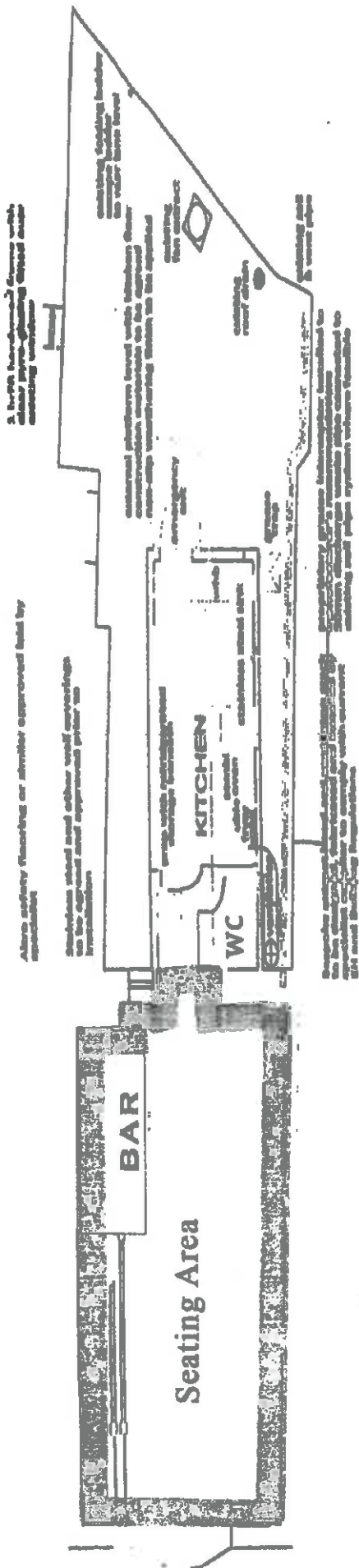

FIRST FLOOR PLAN

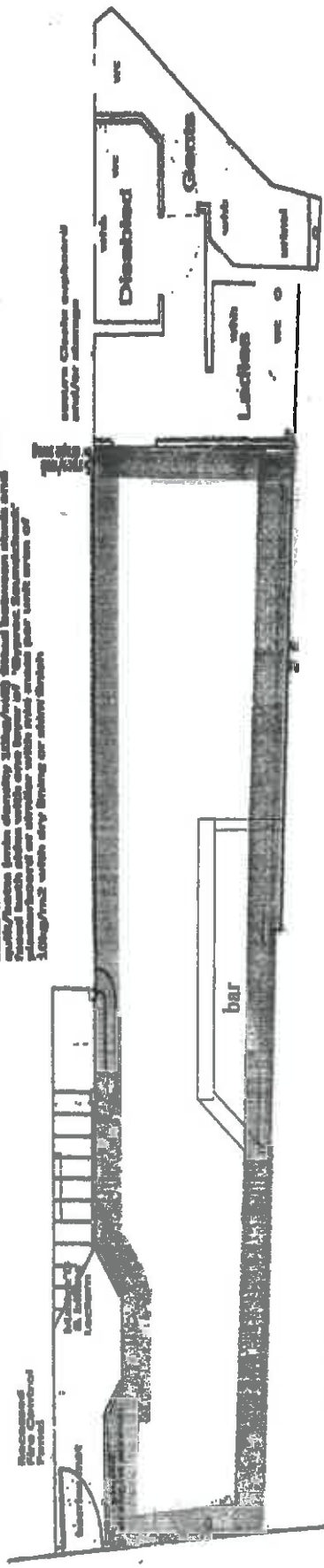

GROUND FLOOR PLAN

LICENCED AREA FOR ALL LICENSABLE ACTIVITIES

BASEMENT FIRE INSTALLATION :

SECURITY INTRUDER ALARM INSTALLATION TO PD6662 Grade 2 COMPLIANCE
 Details not indicated for security

PROPOSED FIRE ALARM SYSTEM TP BS5838 PART 1:2008, CATEGORY L2
 Refer to floor plans and separate Schedule

- Call Point
- Smoke Sensor
- Heat Sensor
- Base Sounder
- Wall Sounder/Stroke
- Fire Break/curtain
- Fire Staircase

Standard wheelchair access to bar area
 Standard wheelchair access to Disabled WC
 Standard wheelchair access to Loo

ANNEX 4 - PLANS
Client: Sir Gar, Carmarthenhire
DATE: 28/04/20/L
LIC NO: GOMU - PRM - 01213
PAGE 1 OF 1
LICENSED AREA(S): All licensable activities authorized by this Licence.

